

PRZEKROJE POPRZECZNE DROGI WOJEWÓDZKIEJ NR 664 OD KM 47+200 DO KM 47+700

SKALA 1:10/100

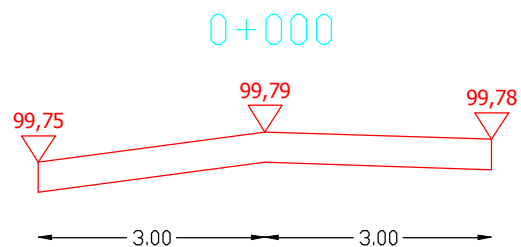

Pwyr.=0,0000 m²

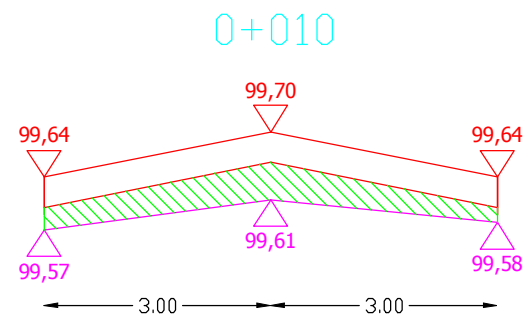

Pwyr.=0,2250 m²

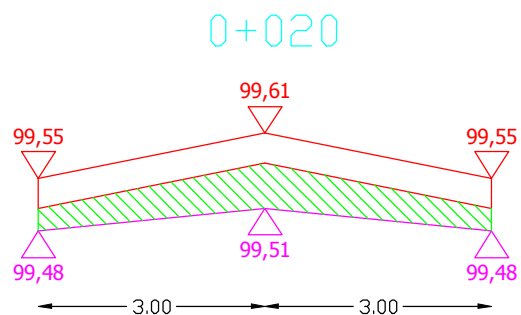

Pwyr.=0,2700 m²

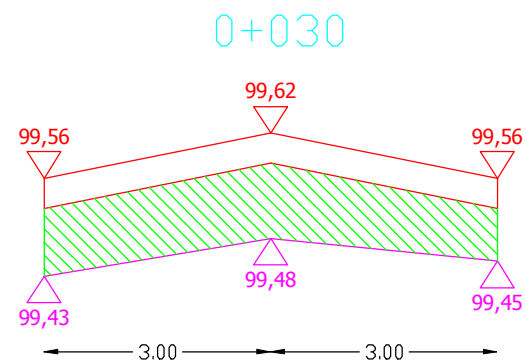

Pwyr.=0,5400 m²

Sporządził:

PRZEKROJE POPRZECZNE DROGI WOJEWÓDZKIEJ NR 664 OD KM 47+200 DO KM 47+700

SKALA 1:10/100

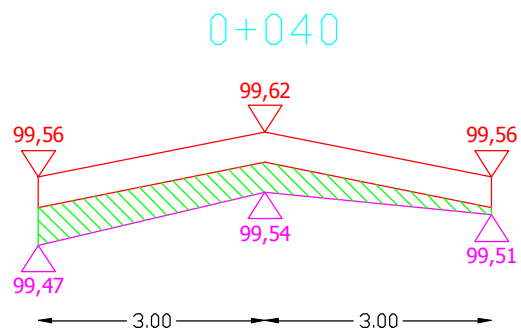

Pwyr.=0,2100 m²

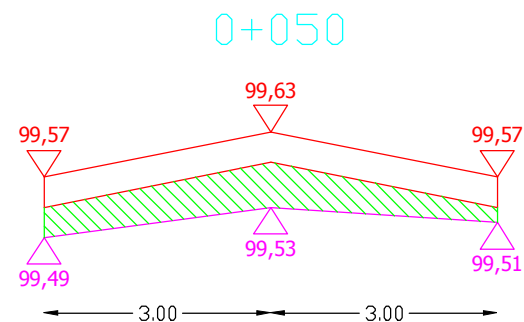

Pwyr.=0,2700 m²

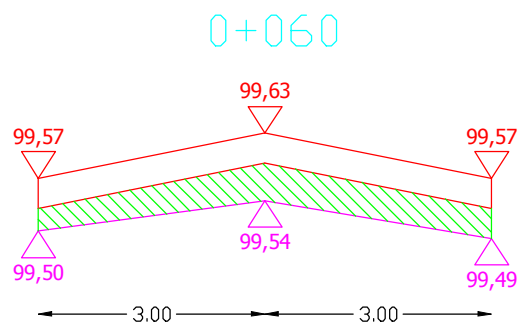

Pwyr.=0,2550 m²

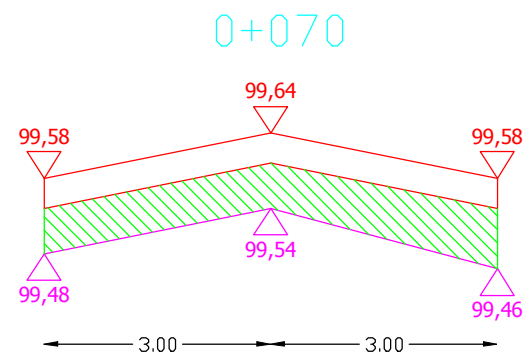

Pwyr.=0,3900 m²

Sporządził:

PRZEKROJE POPRZECZNE DROGI WOJEWÓDZKIEJ NR 664 OD KM 47+200 DO KM 47+700

SKALA 1:10/100

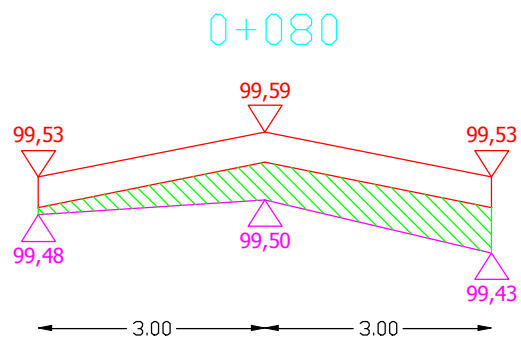

Pwyr.=0,2550 m²

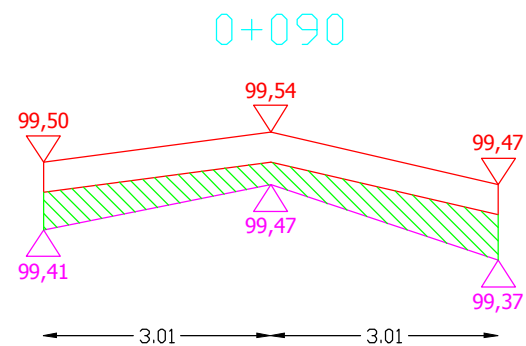

Pwyr.=0,2559 m²

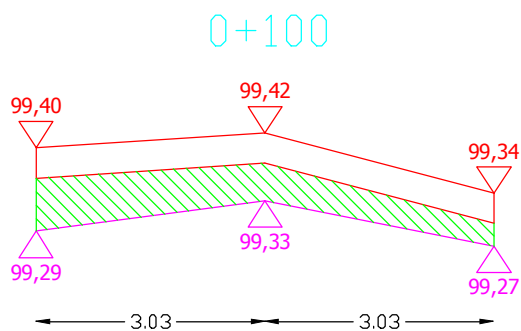

Pwyr.=0,3030 m²

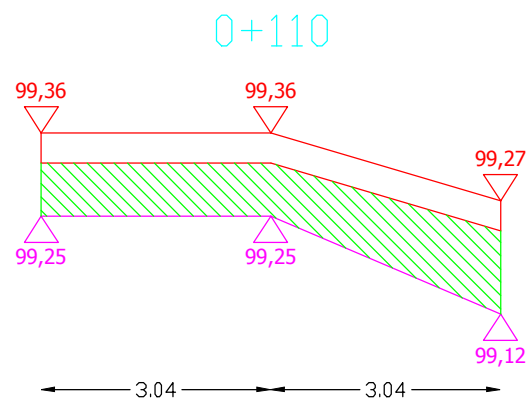

Pwyr.=0,4864 m²

Sporządził:

PRZEKROJE POPRZECZNE DROGI WOJEWÓDZKIEJ NR 664 OD KM 47+200 DO KM 47+700

SKALA 1:10/100

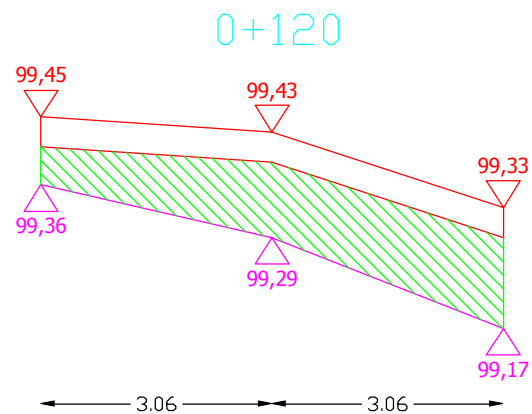

$P_{wyr.}=0,5661 \text{ m}^2$

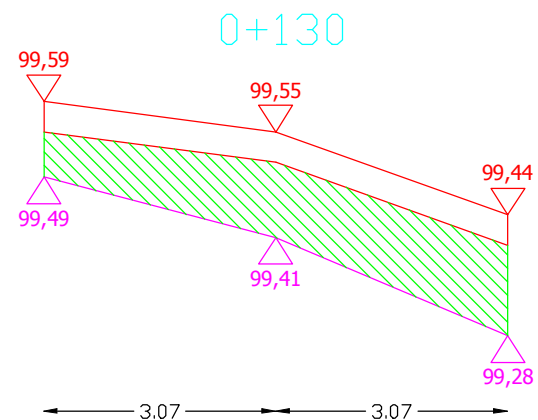

$P_{wyr.}=0,5833 \text{ m}^2$

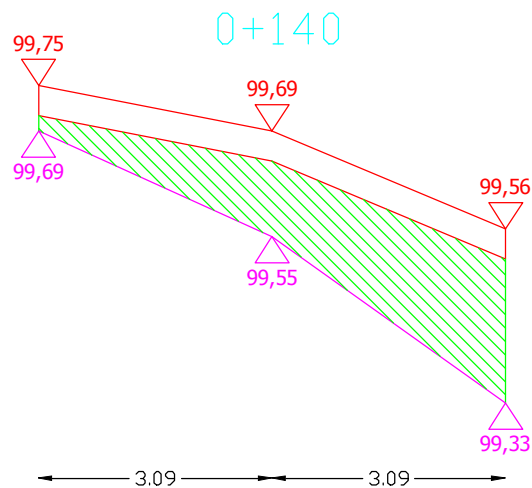

$P_{wyr.}=0,6335 \text{ m}^2$

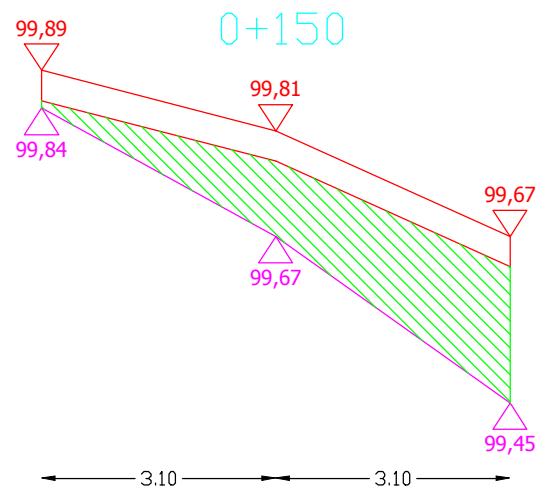

$P_{wyr.}=0,6045 \text{ m}^2$

Sporządził:

PRZEKROJE POPRZECZNE DROGI WOJEWÓDZKIEJ NR 664 OD KM 47+200 DO KM 47+700

SKALA 1:10/100

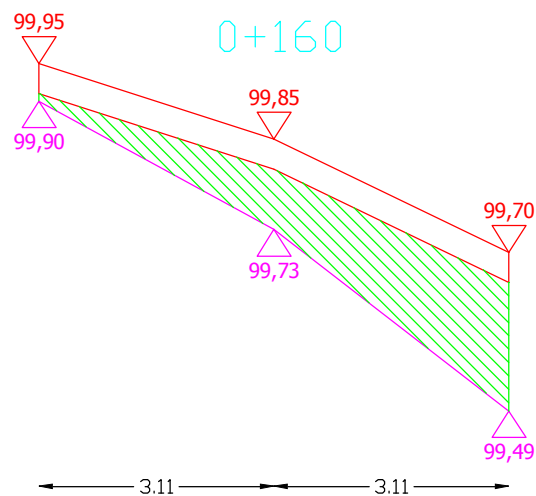

Pwyr.=0,5287 m²

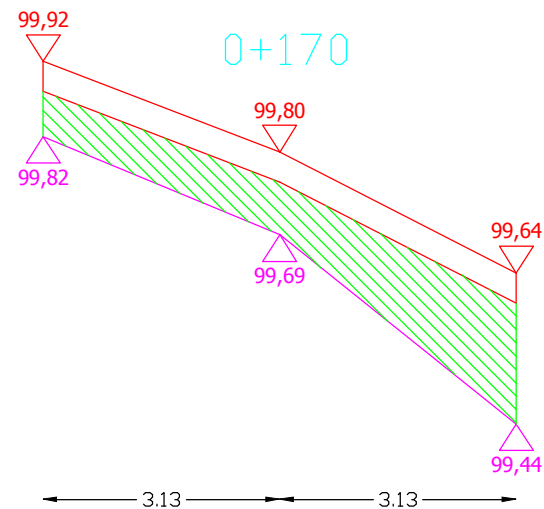

Pwyr.=0,5634 m²

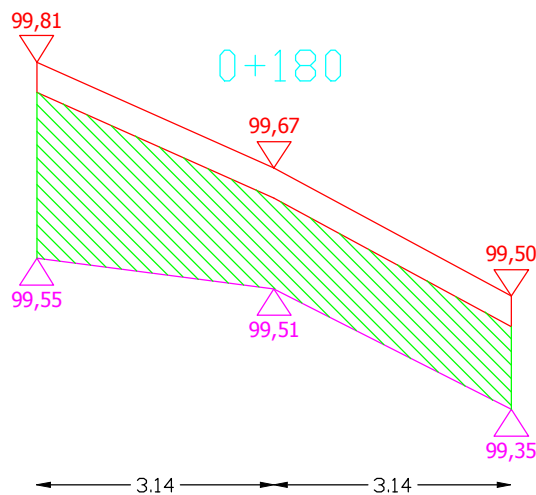

Pwyr.=0,8949 m²

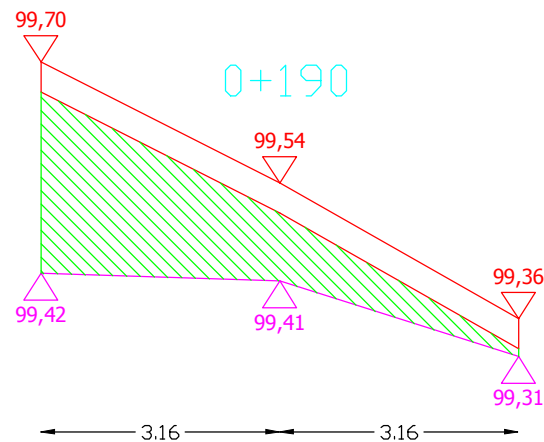

Pwyr.=0,6794 m²

Sporządził:

PRZEKROJE POPRZECZNE DROGI WOJEWÓDZKIEJ NR 664 OD KM 47+200 DO KM 47+700

SKALA 1:10/100

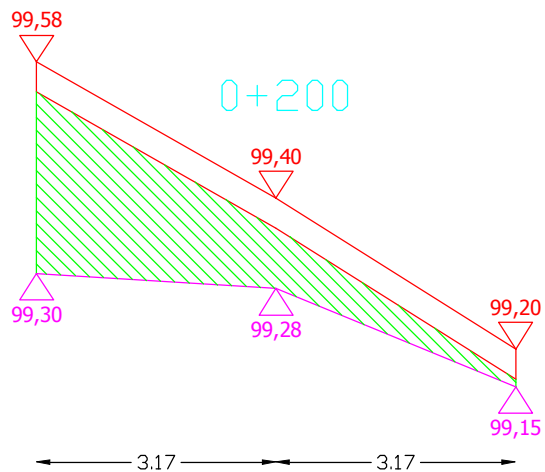

$P_{wyr.}=0,6499 \text{ m}^2$

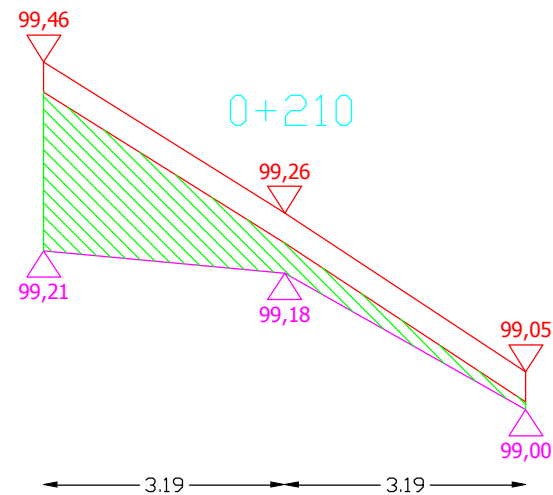

$P_{wyr.}=0,4785 \text{ m}^2$

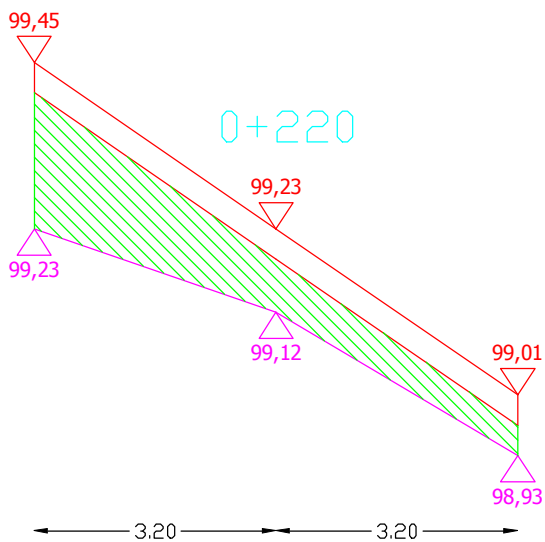

$P_{wyr.}=0,5760 \text{ m}^2$

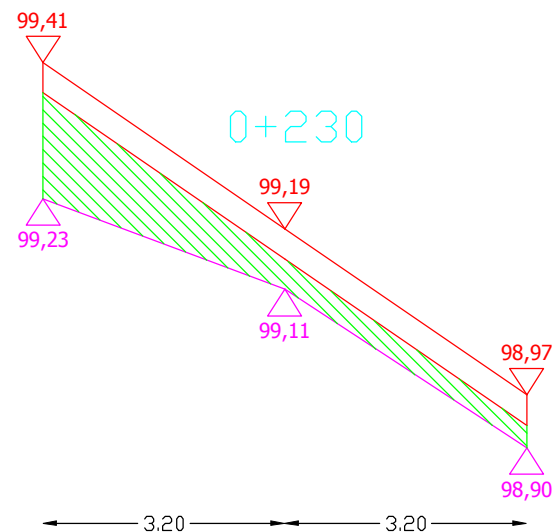

$P_{wyr.}=0,4000 \text{ m}^2$

Sporządził:

PRZEKROJE POPRZECZNE DROGI WOJEWÓDZKIEJ NR 664 OD KM 47+200 DO KM 47+700

SKALA 1:10/100

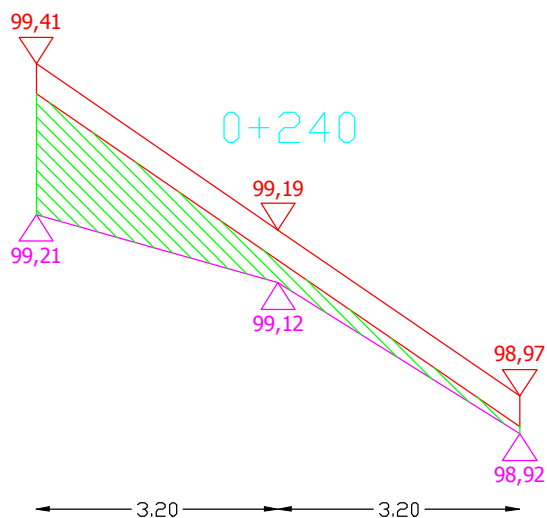

$P_{wyr.}=0,3680 \text{ m}^2$

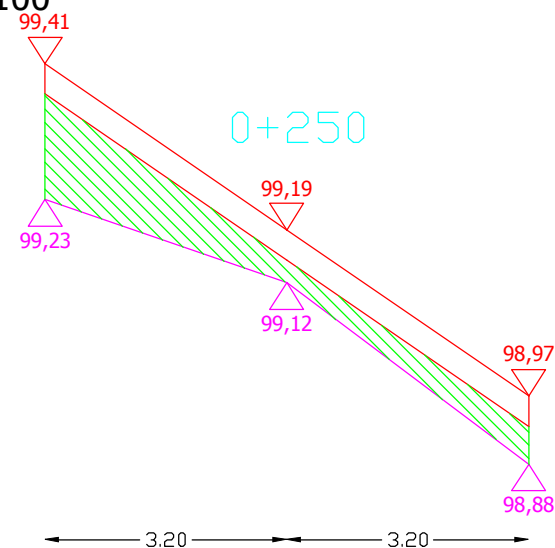

$P_{wyr.}=0,4000 \text{ m}^2$

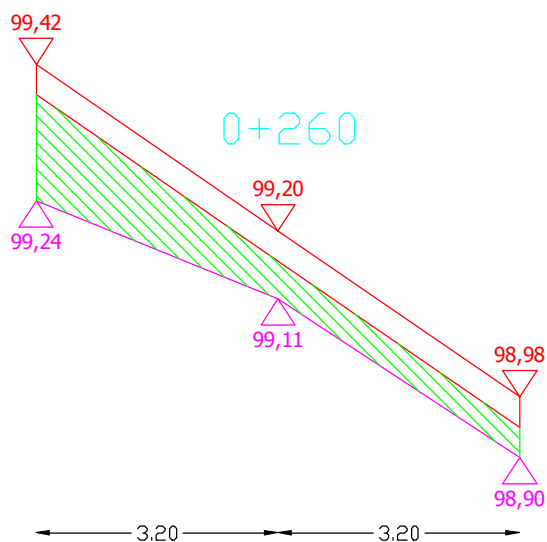

$P_{wyr.}=0,4480 \text{ m}^2$

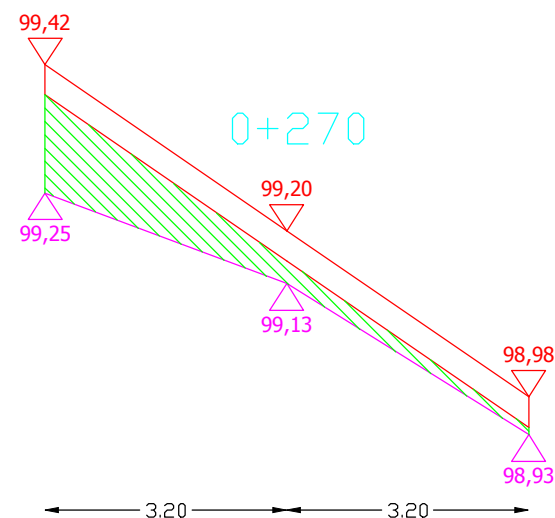

$P_{wyr.}=0,3200 \text{ m}^2$

Sporządził:

PRZEKROJE POPRZECZNE DROGI WOJEWÓDZKIEJ NR 664 OD KM 47+200 DO KM 47+700

SKALA 1:10/100

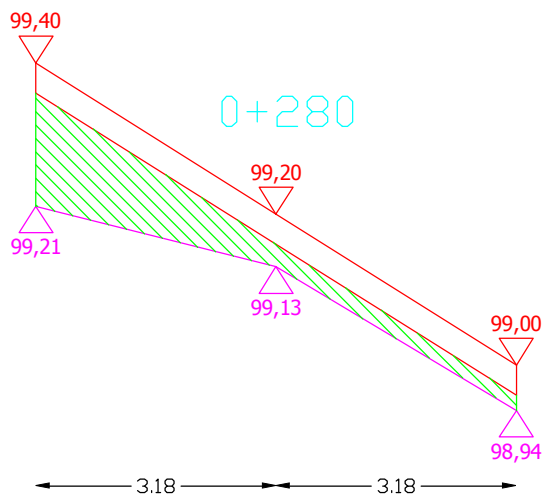

$P_{wyr.}=0,3657 \text{ m}^2$

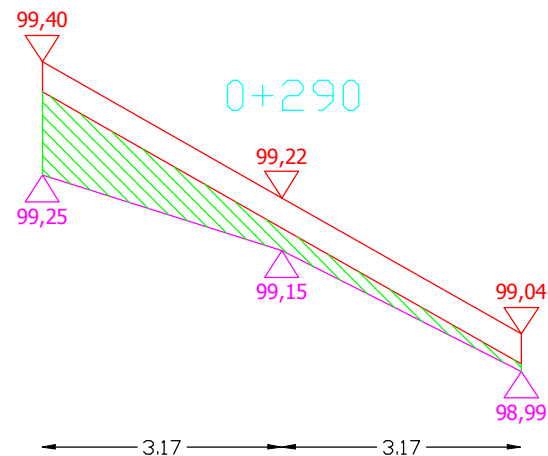

$P_{wyr.}=0,2853 \text{ m}^2$

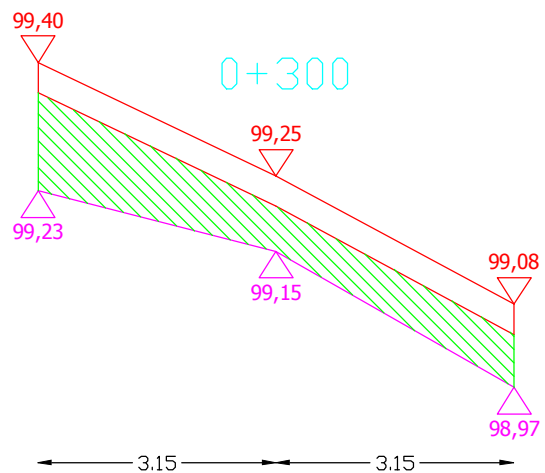

$P_{wyr.}=0,5040 \text{ m}^2$

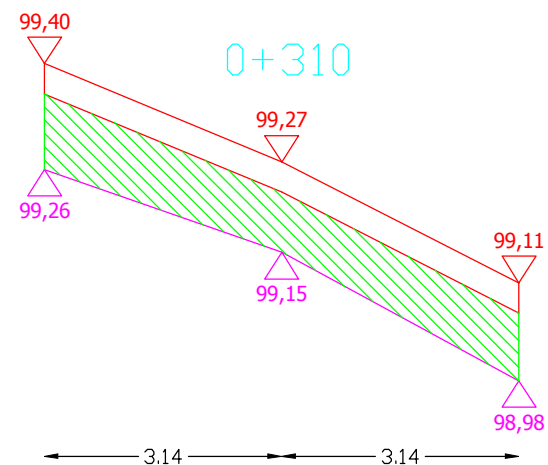

$P_{wyr.}=0,5495 \text{ m}^2$

Sporządził:

PRZEKROJE POPRZECZNE DROGI WOJEWÓDZKIEJ NR 664 OD KM 47+200 DO KM 47+700

SKALA 1:10/100

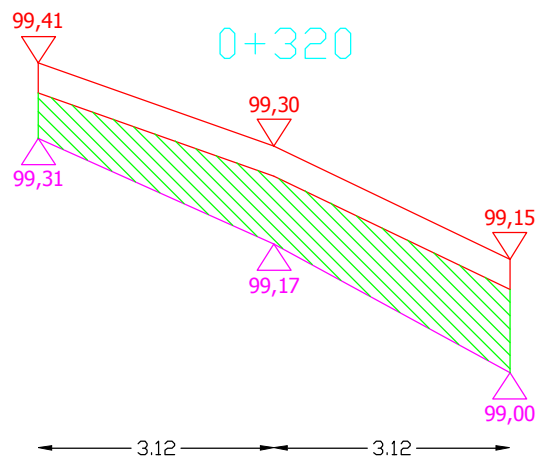

$P_{wyr.}=0,5460 \text{ m}^2$

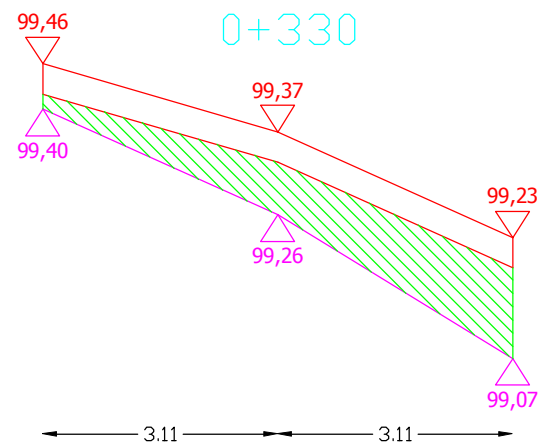

$P_{wyr.}=0,4354 \text{ m}^2$

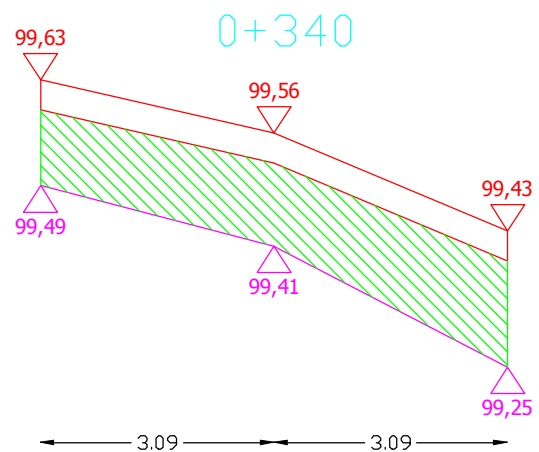

$P_{wyr.}=0,7107 \text{ m}^2$

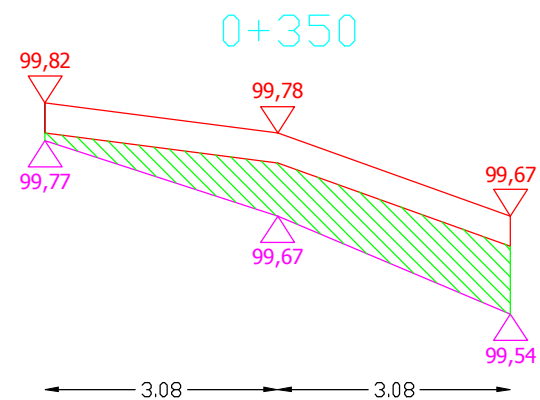

$P_{wyr.}=0,3696 \text{ m}^2$

Sporządził:

PRZEKROJE POPRZECZNE DROGI WOJEWÓDZKIEJ NR 664 OD KM 47+200 DO KM 47+700

SKALA 1:10/100

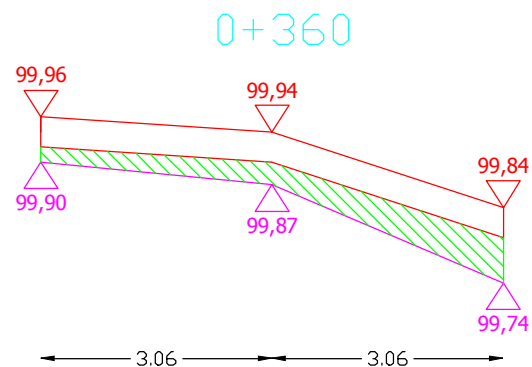

Pwyr.=0,2142 m²

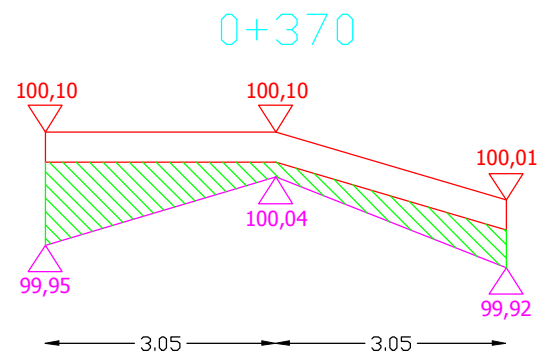

Pwyr.=0,3050 m²

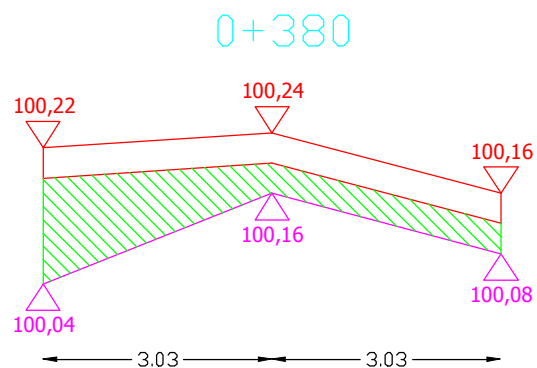

Pwyr.=0,3939 m²

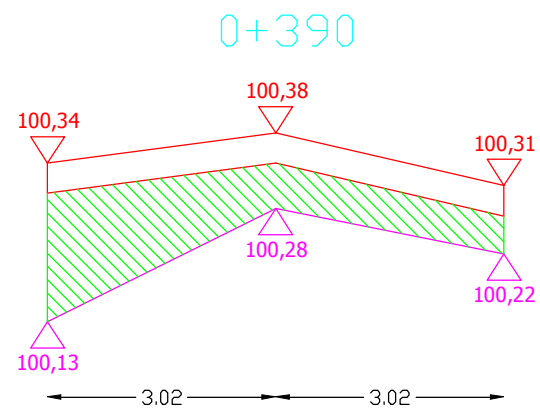

Pwyr.=0,5134 m²

Sporządził:

PRZEKROJE POPRZECZNE DROGI WOJEWÓDZKIEJ NR 664 OD KM 47+200 DO KM 47+700

SKALA 1:10/100

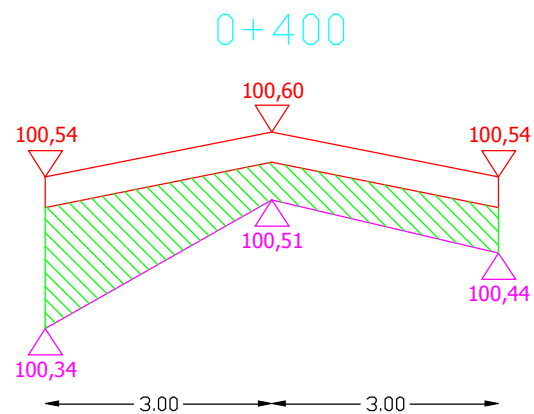

Pwyr.=0,4800 m²

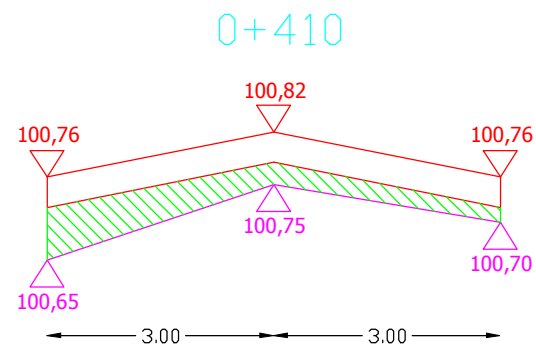

Pwyr.=0,2250 m²

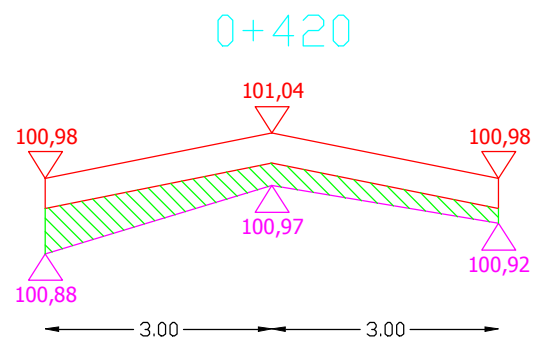

Pwyr.=0,2100 m²

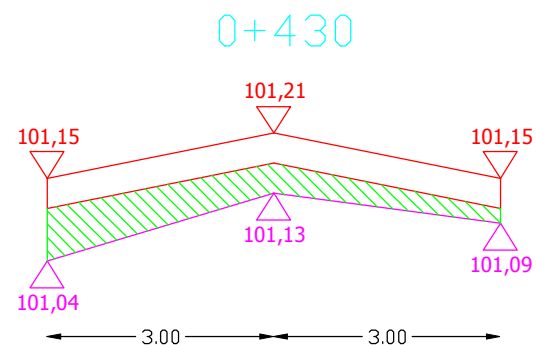

Pwyr.=0,2550 m²

Sporządził:

PRZEKROJE POPRZECZNE DROGI WOJEWÓDZKIEJ NR 664 OD KM 47+200 DO KM 47+700

SKALA 1:10/100

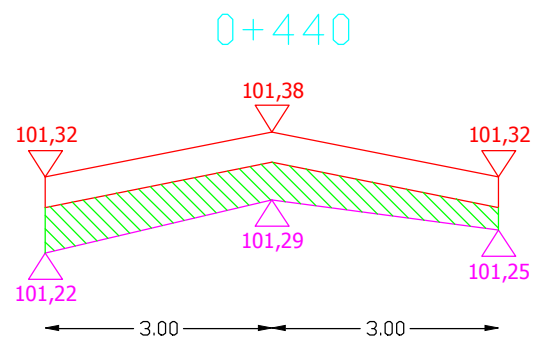

Pwyr.=0,2850 m²

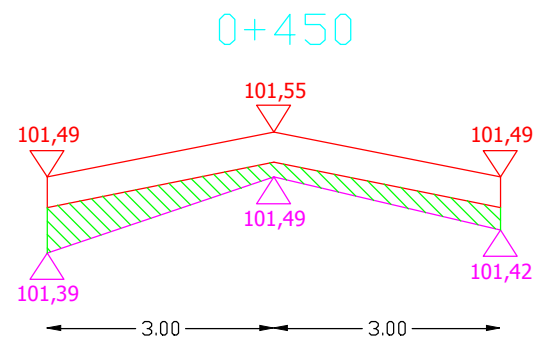

Pwyr.=0,1950 m²

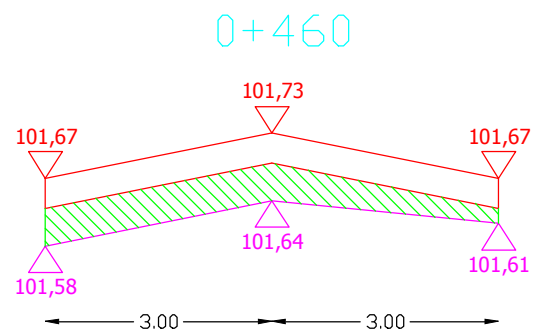

Pwyr.=0,2550 m²

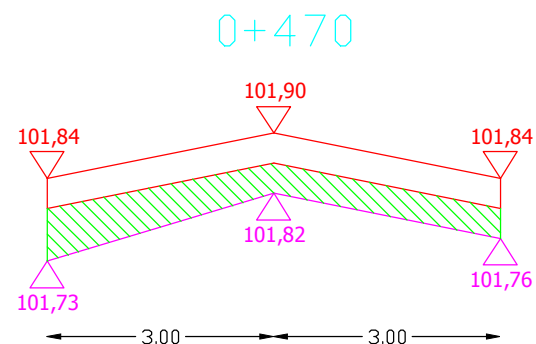

Pwyr.=0,2850 m²

Sporządził:

PRZEKROJE POPRZECZNE DROGI WOJEWÓDZKIEJ NR 664 OD KM 47+200 DO KM 47+700

SKALA 1:10/100

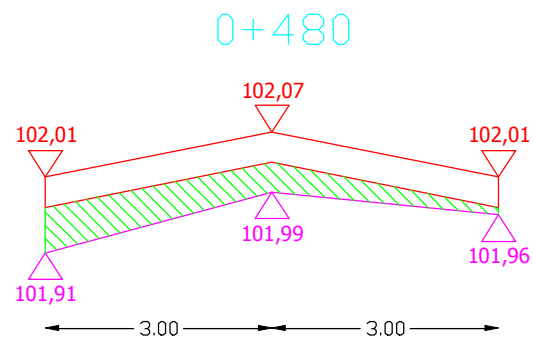

Pwyr.=0,2250 m²

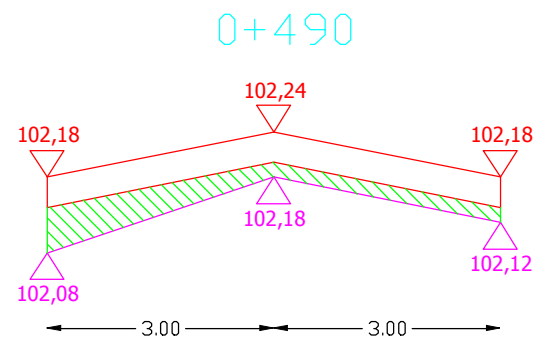

Pwyr.=0,1800 m²

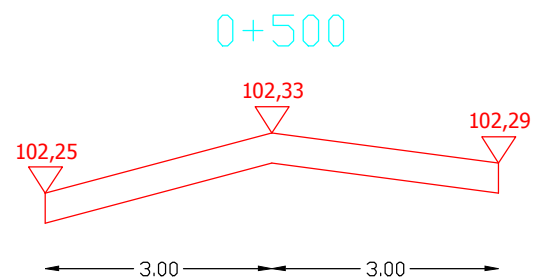

Pwyr.=0,0000 m²

Sporządził: