

PRZEKROJE POPRZECZNE DROGI WOJEWÓDZKIEJ NR 651 OD KM 39+358 DO KM 39+828

SKALA 1:10/100

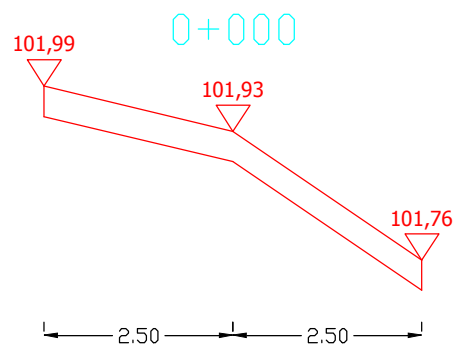

Pwyr.=0,0000 m²

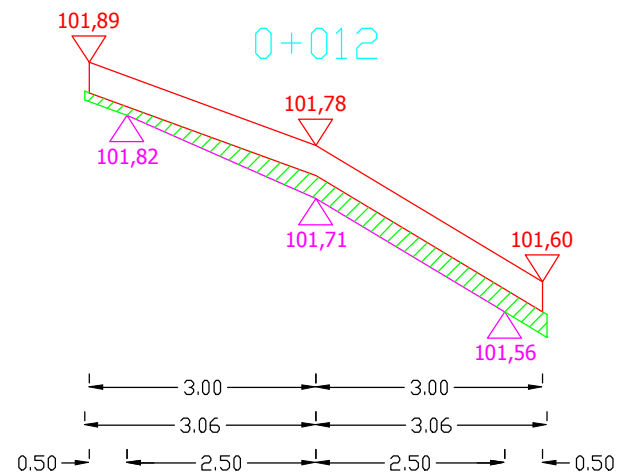

Pwyr.=0,1504 m²

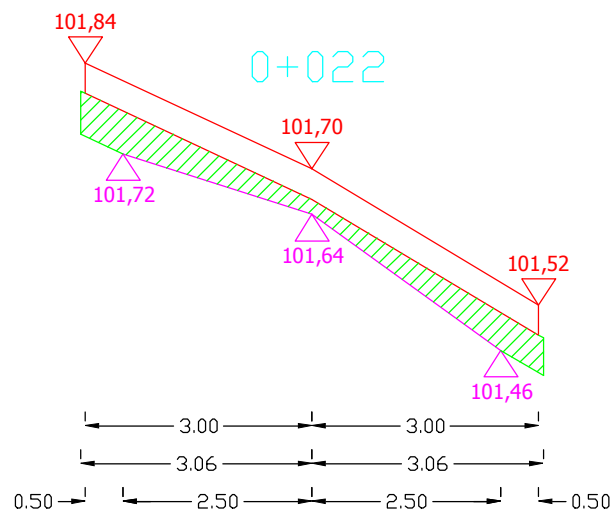

Pwyr.=0,2431 m²

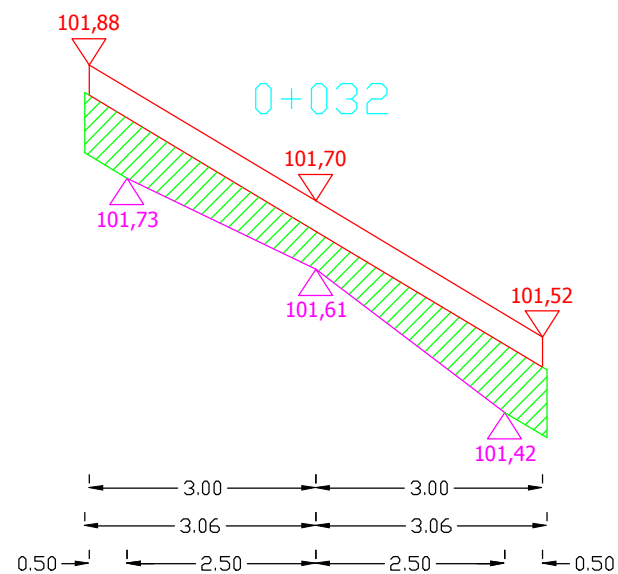

Pwyr.=0,4327 m²

Sporządził:

PRZEKROJE POPRZECZNE DROGI WOJEWÓDZKIEJ NR 651 OD KM 39+358 DO KM 39+828

SKALA 1:10/100

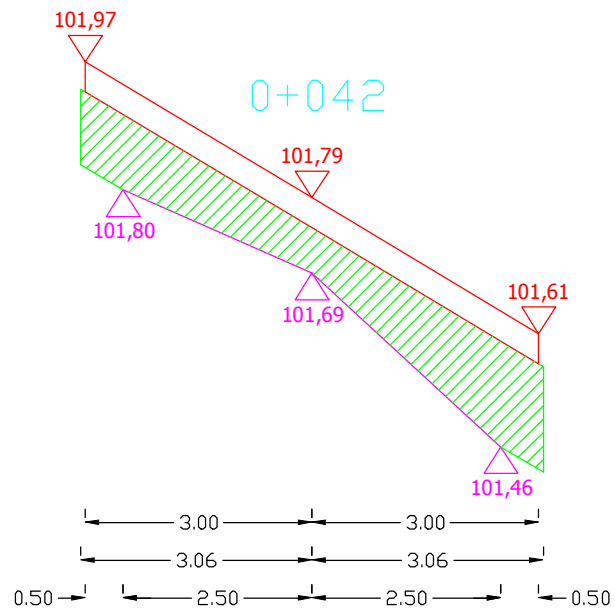

Pwyr.=0,5844 m²

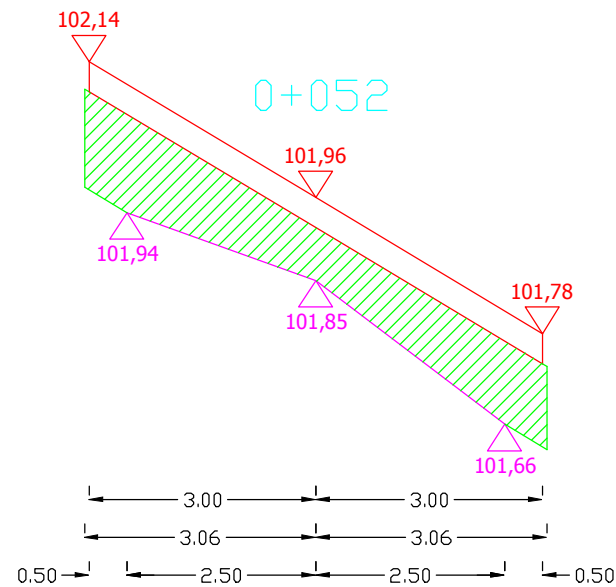

Pwyr.=0,6094 m²

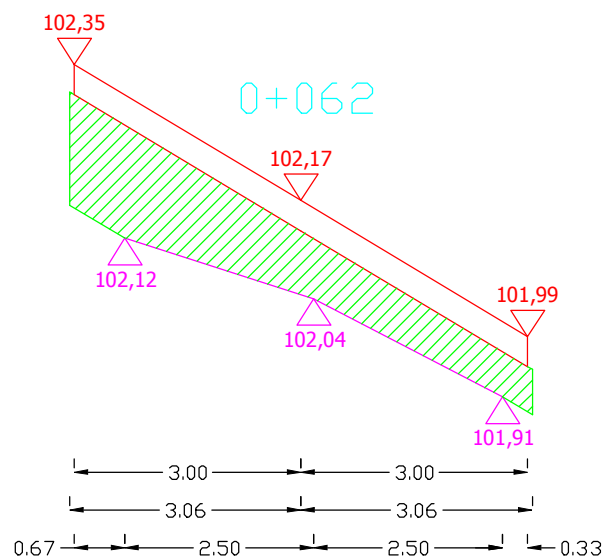

Pwyr.=0,5942 m²

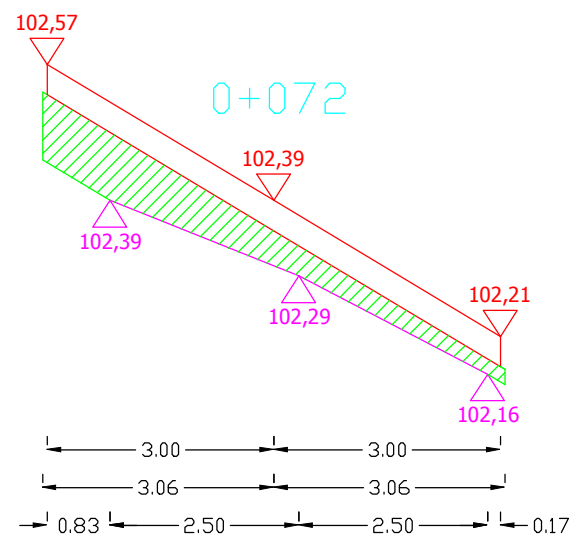

Pwyr.=0,3234 m²

Sporządził:

PRZEKROJE POPRZECZNE DROGI WOJEWÓDZKIEJ NR 651 OD KM 39+358 DO KM 39+828

SKALA 1:10/100

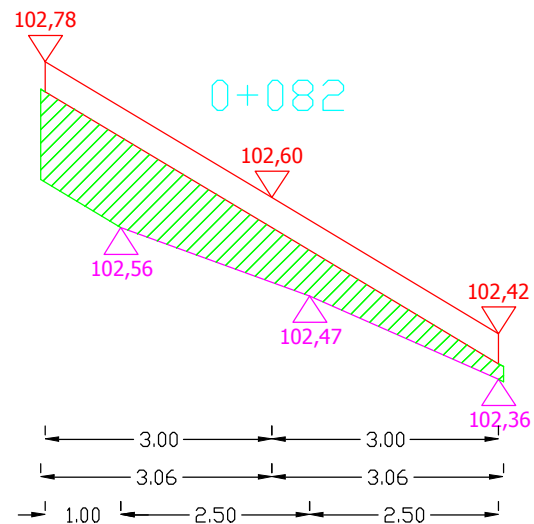

Pwyr.=0,4534 m²

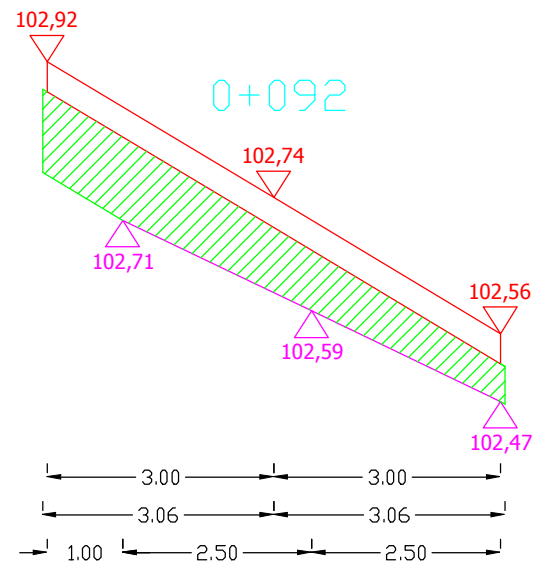

Pwyr.=0,5196 m²

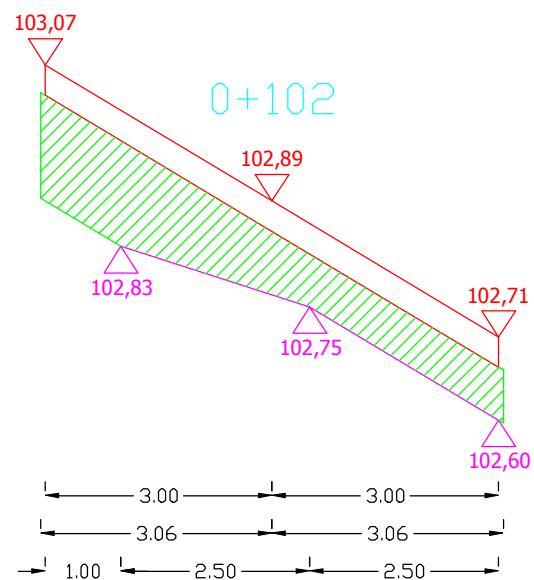

Pwyr.=0,5901 m²

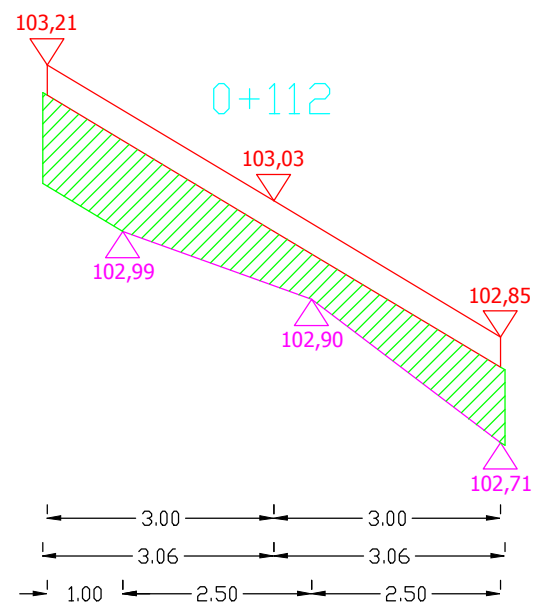

Pwyr.=0,5582 m²

Sporządził:

PRZEKROJE POPRZECZNE DROGI WOJEWÓDZKIEJ NR 651 OD KM 39+358 DO KM 39+828

SKALA 1:10/100

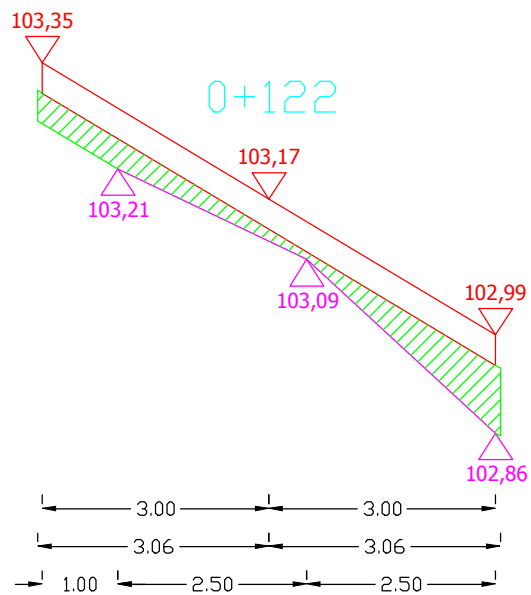

Pwyr.=0,2353 m²

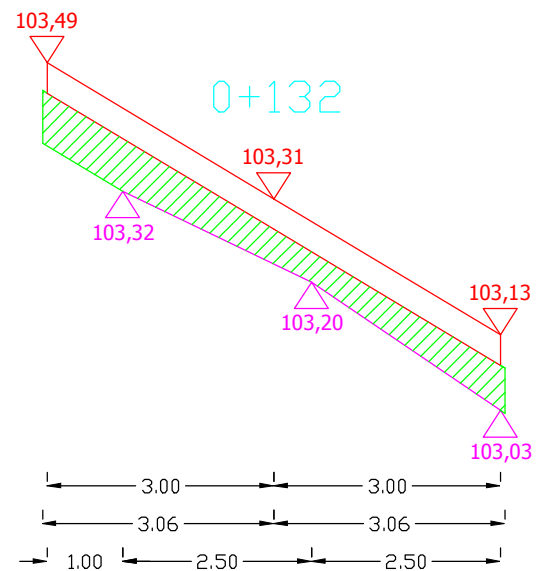

Pwyr.=0,3403 m²

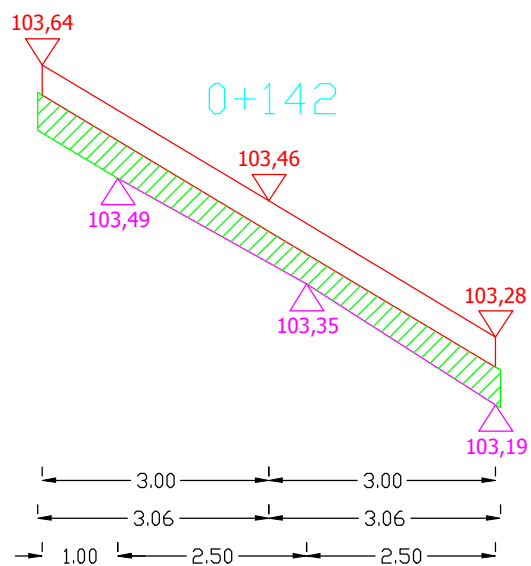

Pwyr.=0,2810 m²

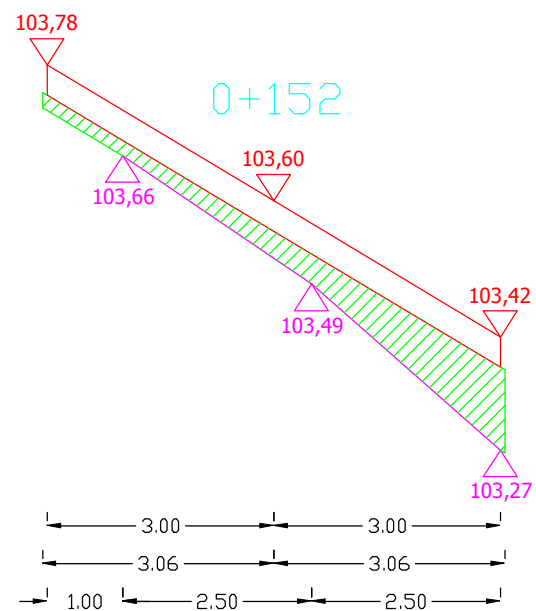

Pwyr.=0,2903 m²

Sporządził:

PRZEKROJE POPRZECZNE DROGI WOJEWÓDZKIEJ NR 651 OD KM 39+358 DO KM 39+828

SKALA 1:10/100

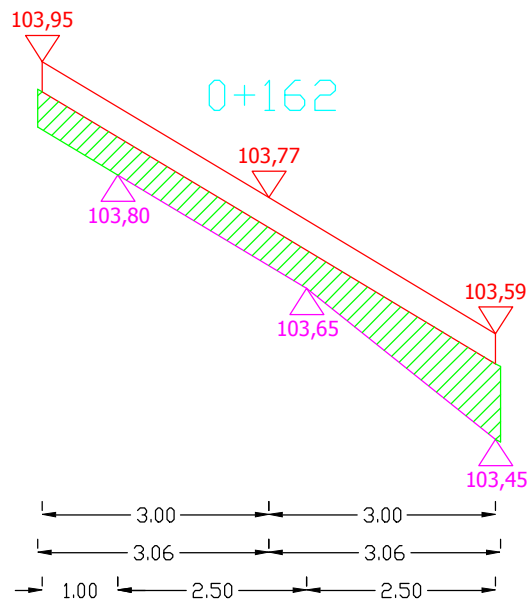

$P_{wyr.}=0,3715 \text{ m}^2$

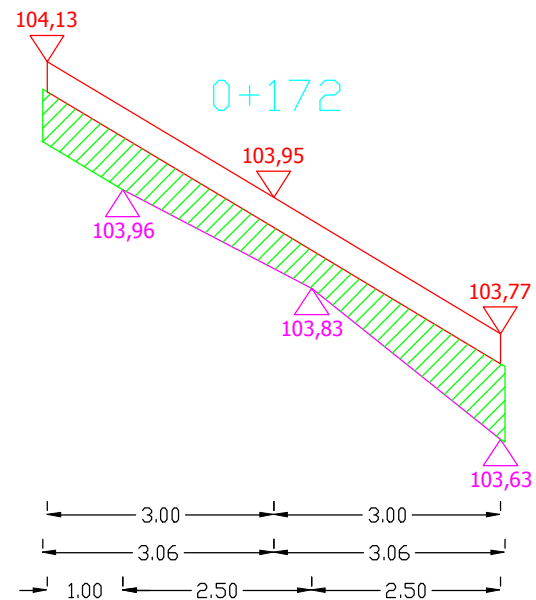

$P_{wyr.}=0,4168 \text{ m}^2$

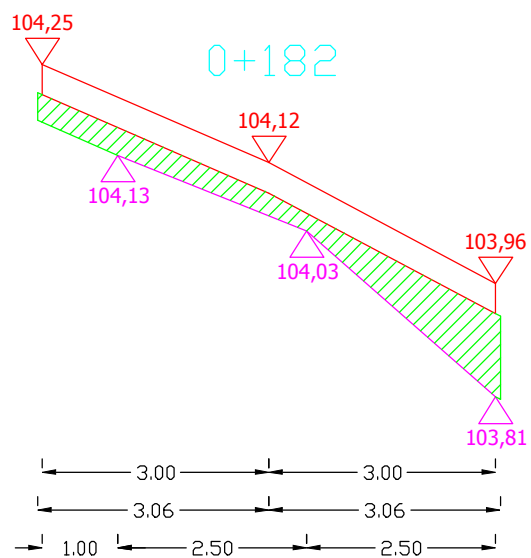

$P_{wyr.}=0,2921 \text{ m}^2$

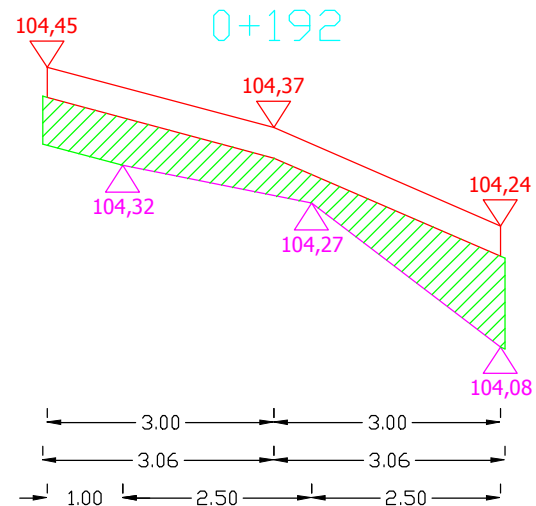

$P_{wyr.}=0,4077 \text{ m}^2$

Sporządził:

PRZEKROJE POPRZECZNE DROGI WOJEWÓDZKIEJ NR 651 OD KM 39+358 DO KM 39+828

SKALA 1:10/100

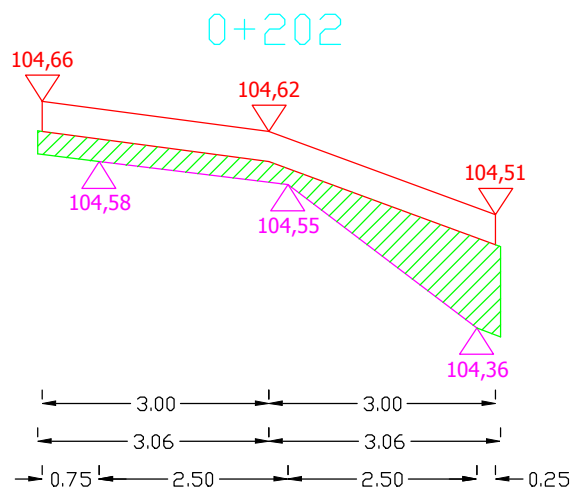

Pwyr.=0,3064 m²

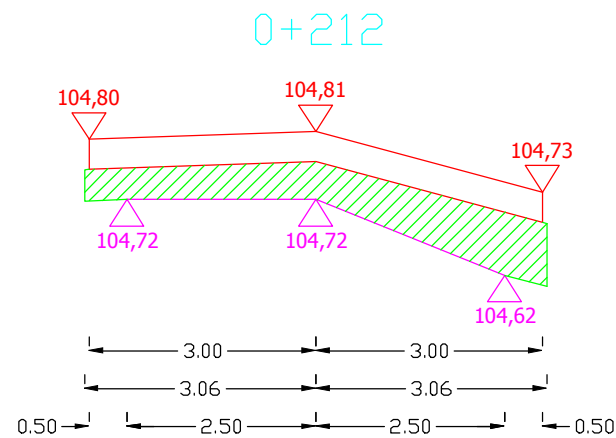

Pwyr.=0,3513 m²

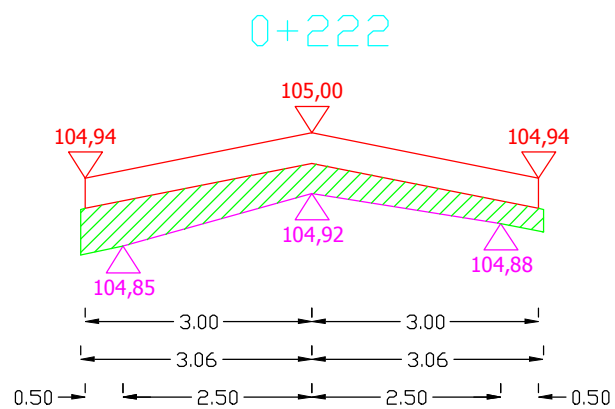

Pwyr.=0,2629 m²

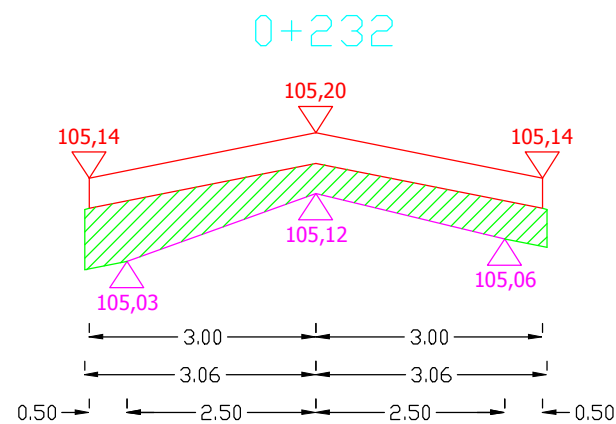

Pwyr.=0,3353 m²

Sporządził:

PRZEKROJE POPRZECZNE DROGI WOJEWÓDZKIEJ NR 651 OD KM 39+358 DO KM 39+828

SKALA 1:10/100

0+242

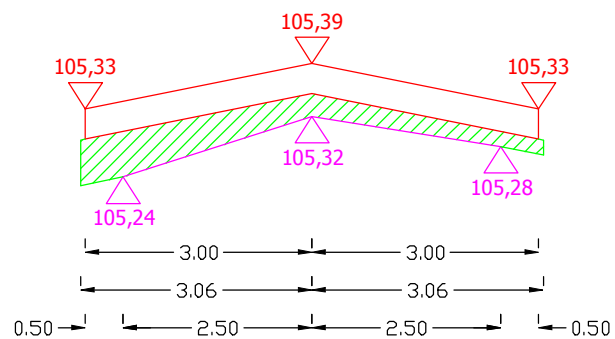

Pwyr.=0,2198 m²

0+252

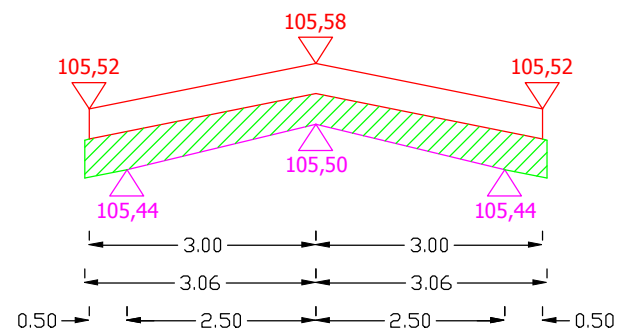

Pwyr.=0,2810 m²

0+262

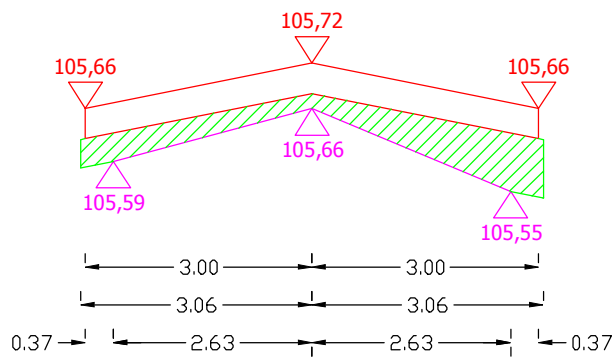

Pwyr.=0,2529 m²

0+272

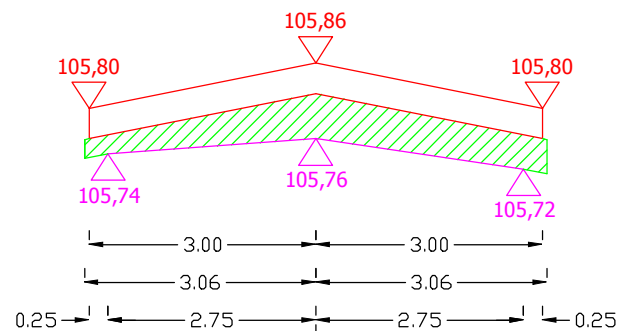

Pwyr.=0,2830 m²

Sporządził:

PRZEKROJE POPRZECZNE DROGI WOJEWÓDZKIEJ NR 651 OD KM 39+358 DO KM 39+828

SKALA 1:10/100

0+282

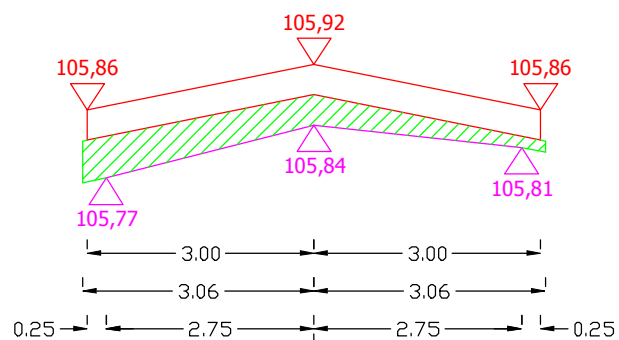

Pwyr.=0,2280 m²

0+292

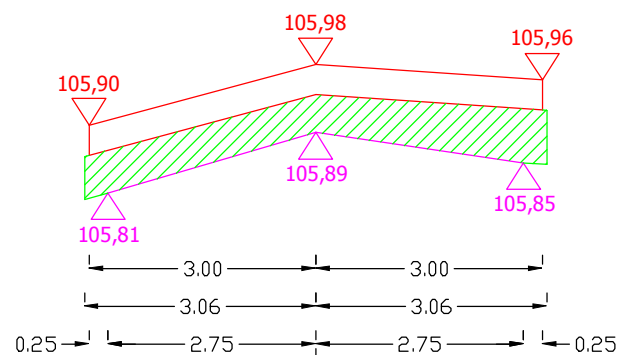

Pwyr.=0,3537 m²

0+302

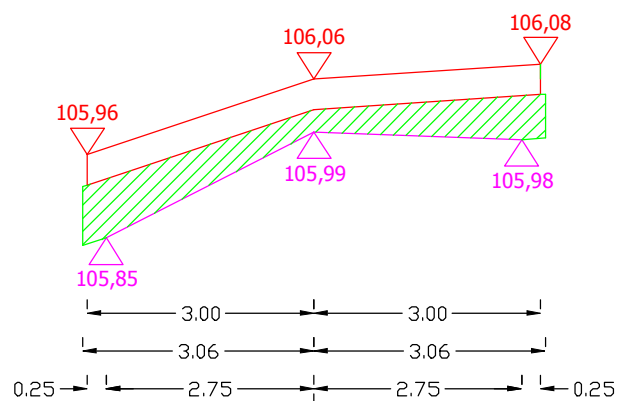

Pwyr.=0,3128 m²

0+312

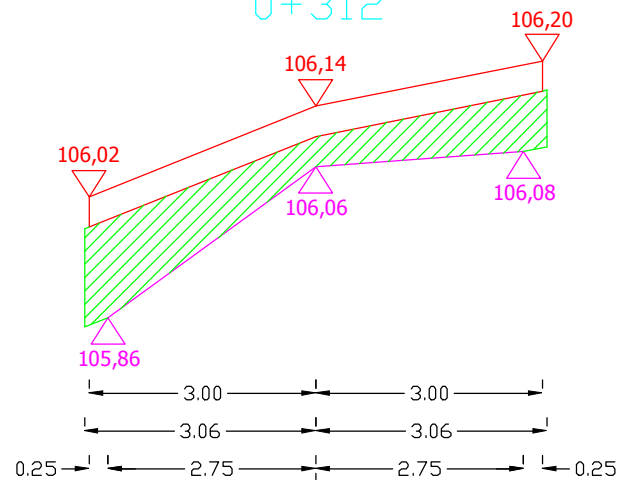

Pwyr.=0,4554 m²

Sporządził:

PRZEKROJE POPRZECZNE DROGI WOJEWÓDZKIEJ NR 651 OD KM 39+358 DO KM 39+828

SKALA 1:10/100

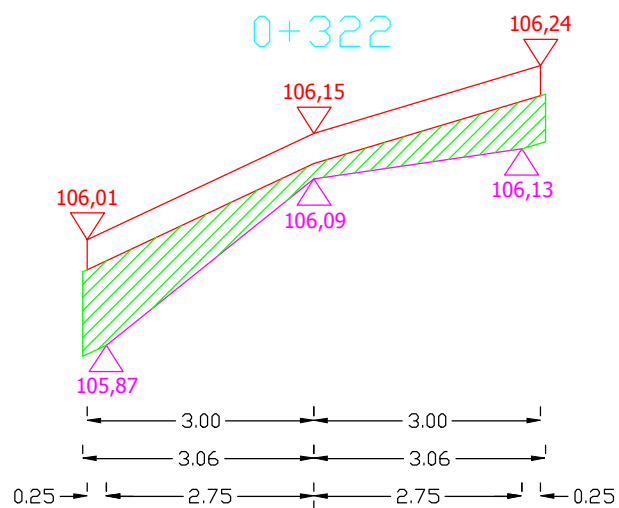

$P_{wyr.}=0,3485 \text{ m}^2$

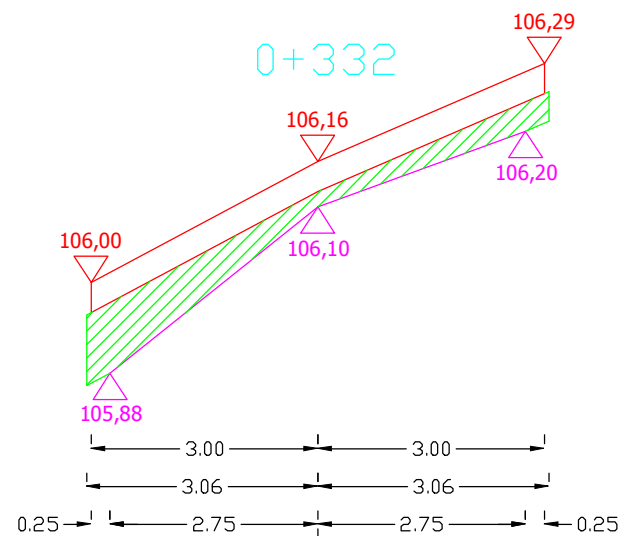

$P_{wyr.}=0,2783 \text{ m}^2$

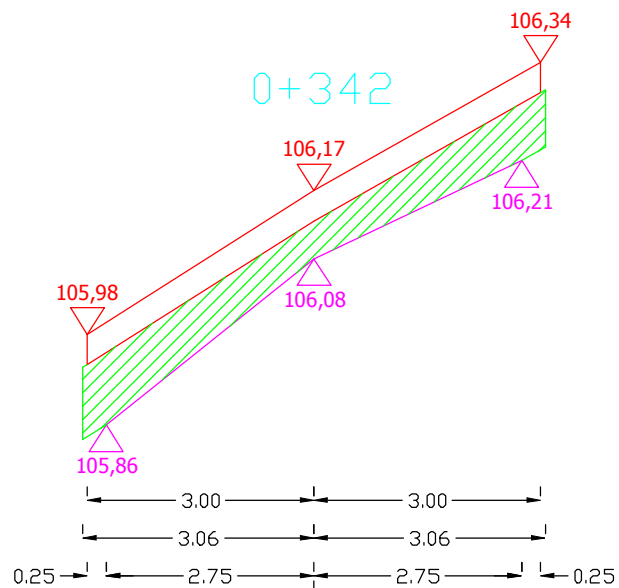

$P_{wyr.}=0,4268 \text{ m}^2$

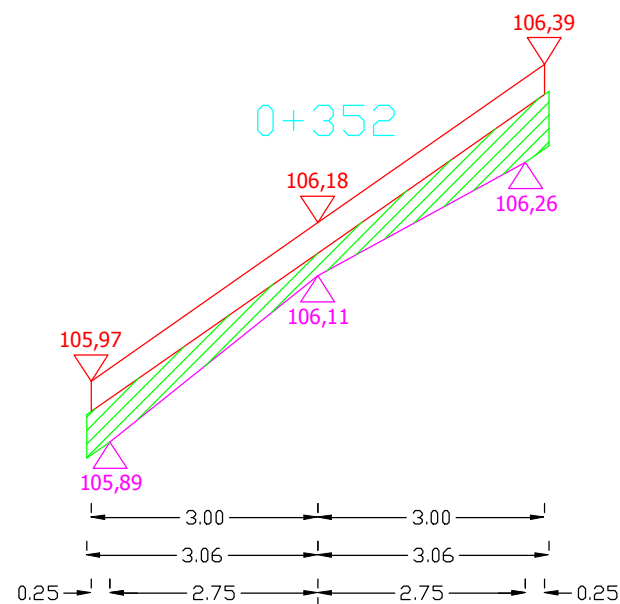

$P_{wyr.}=0,3016 \text{ m}^2$

Sporządził:

PRZEKROJE POPRZECZNE DROGI WOJEWÓDZKIEJ NR 651 OD KM 39+358 DO KM 39+828

SKALA 1:10/100

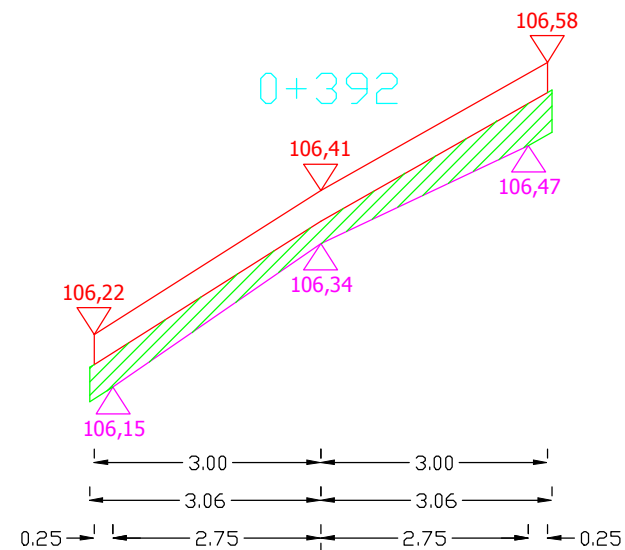
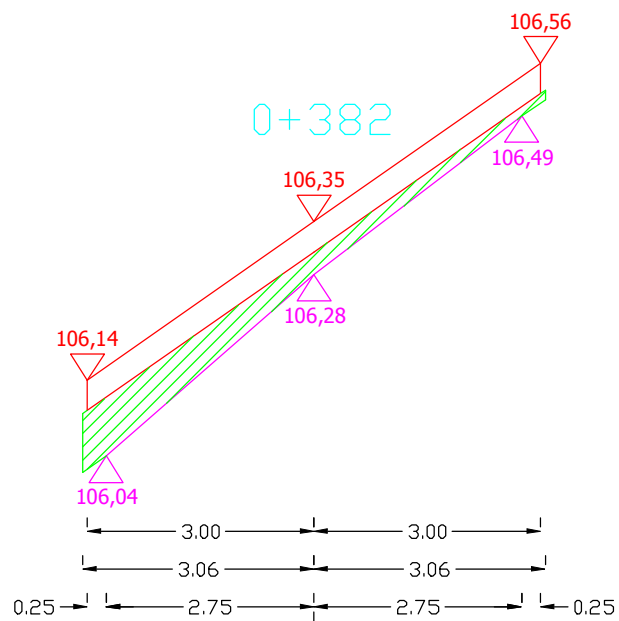
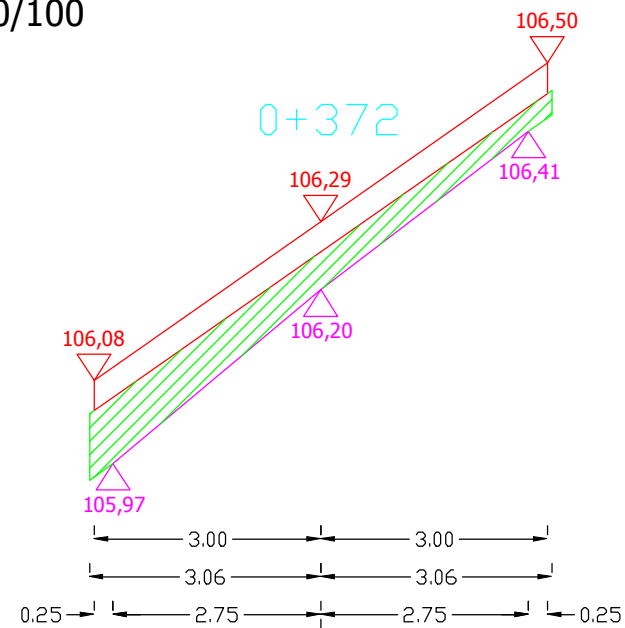
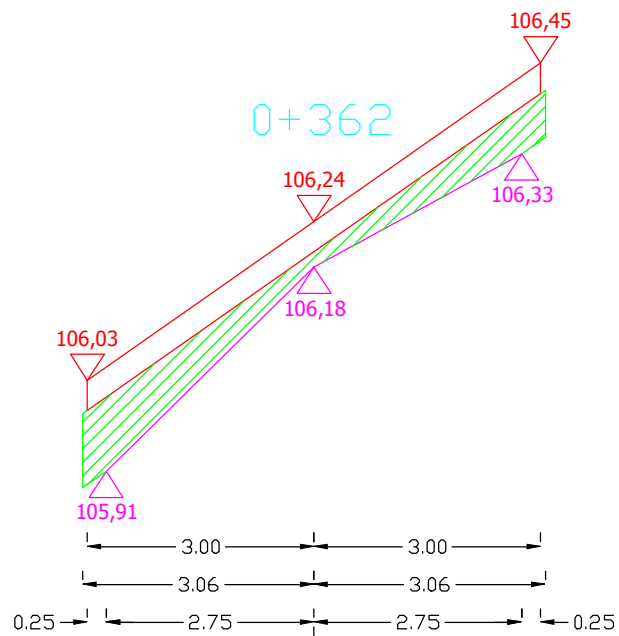

Sporządził:

PRZEKROJE POPRZECZNE DROGI WOJEWÓDZKIEJ NR 651 OD KM 39+358 DO KM 39+828

SKALA 1:10/100

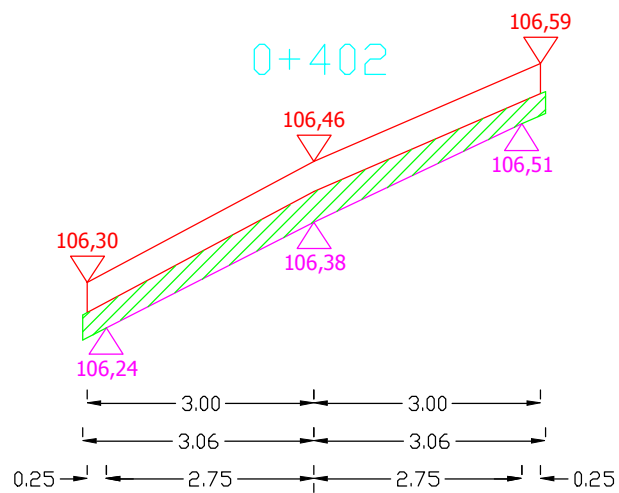

Pwyr.=0,2153 m²

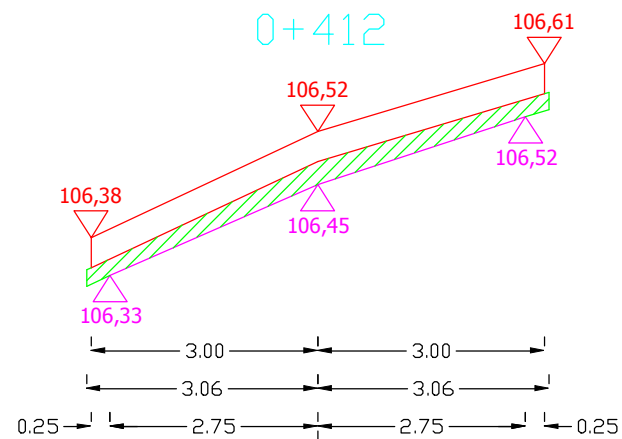

Pwyr.=0,1569 m²

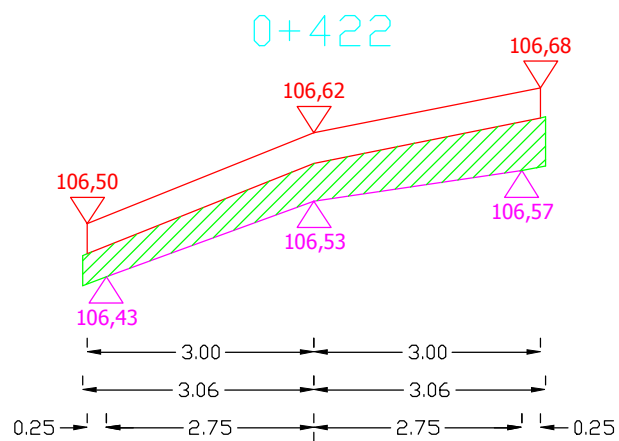

Pwyr.=0,3144 m²

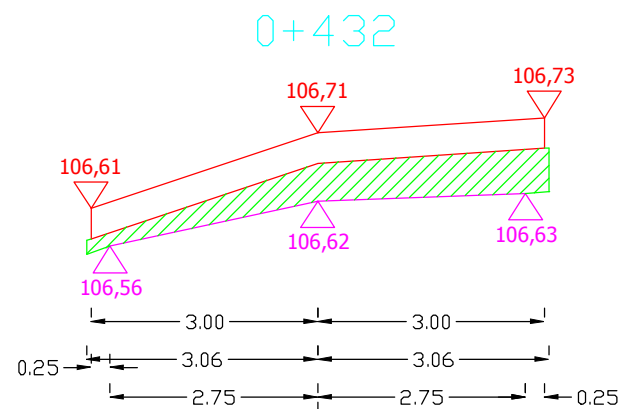

Pwyr.=0,2667 m²

Sporządził:

PRZEKROJE POPRZECZNE DROGI WOJEWÓDZKIEJ NR 651 OD KM 39+358 DO KM 39+828

SKALA 1:10/100

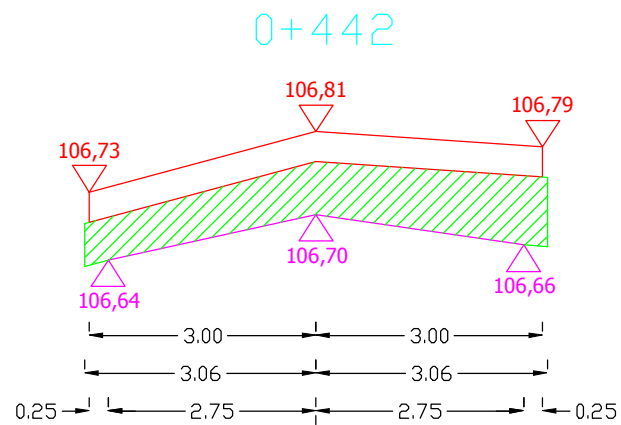

Pwyr.=0,4424 m²

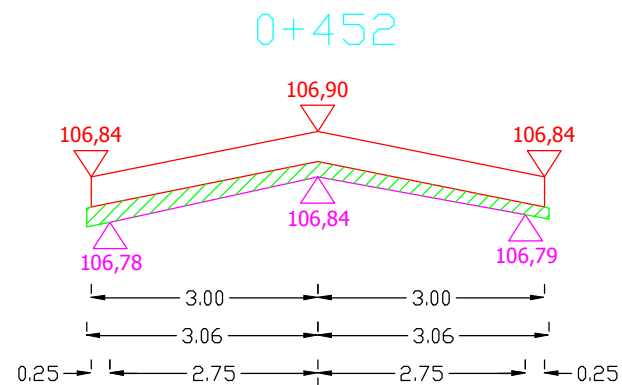

Pwyr.=0,1225 m²

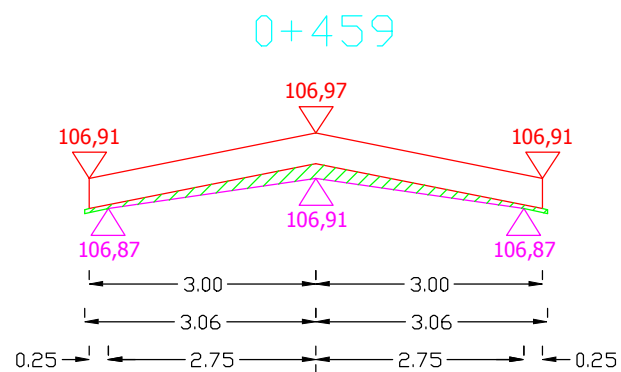

Pwyr.=0,0719 m²

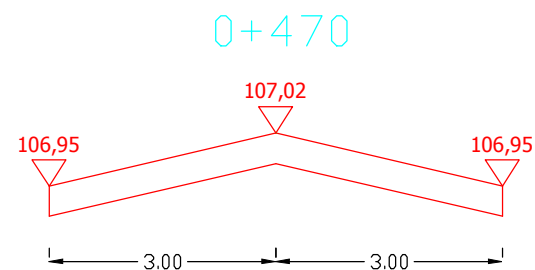

Pwyr.=0,0000 m²

Sporządził: