

PRZEKROJE POPRZECZNE DROGI WOJEWÓDZKIEJ NR 651 OD KM 39+816 DO KM 40+810

SKALA 1:10/100

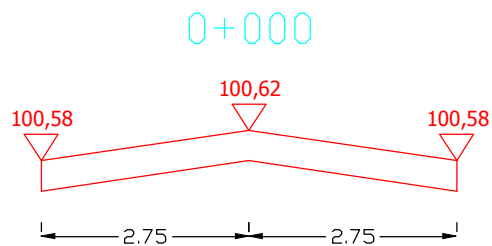

Pwyr.=0,0000 m²

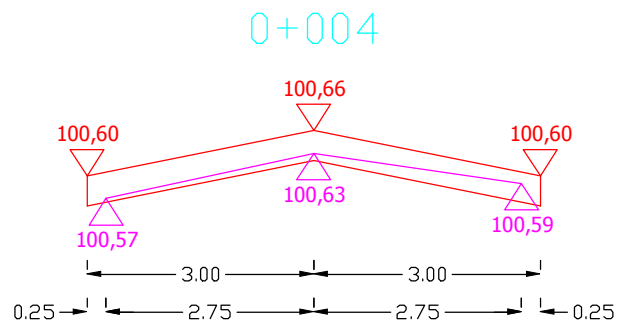

Pwyr.=0,0000 m²

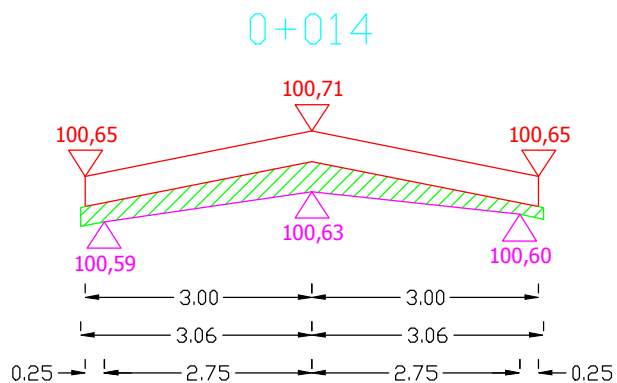

Pwyr.=0,1774 m²

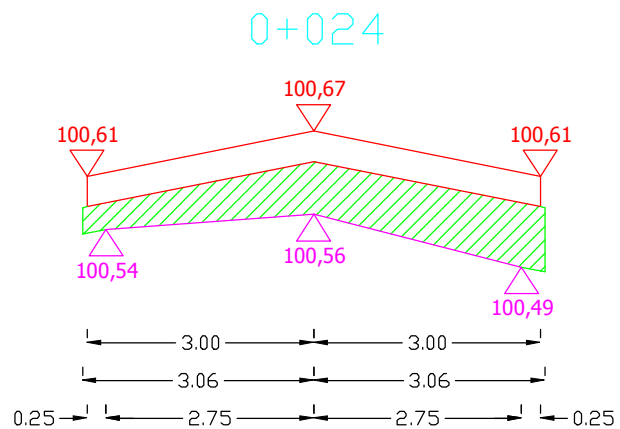

Pwyr.=0,3947 m²

Sporządził:

PRZEKROJE POPRZECZNE DROGI WOJEWÓDZKIEJ NR 651 OD KM 39+816 DO KM 40+810

SKALA 1:10/100

0+034

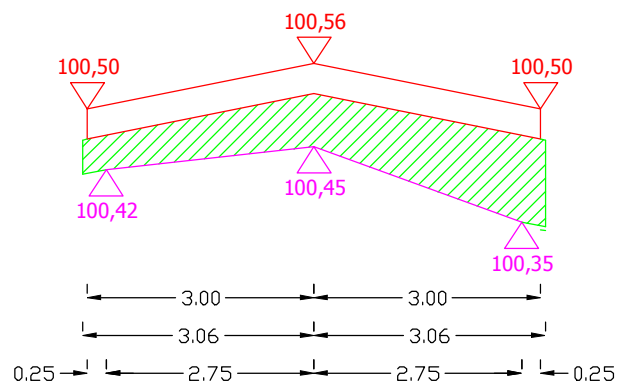

Pwyr.=0,4621 m²

0+044

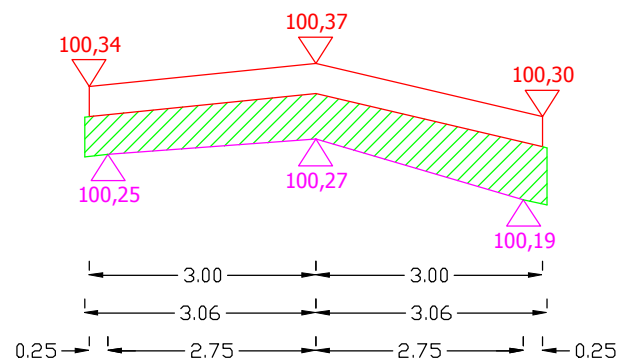

Pwyr.=0,3812 m²

0+054

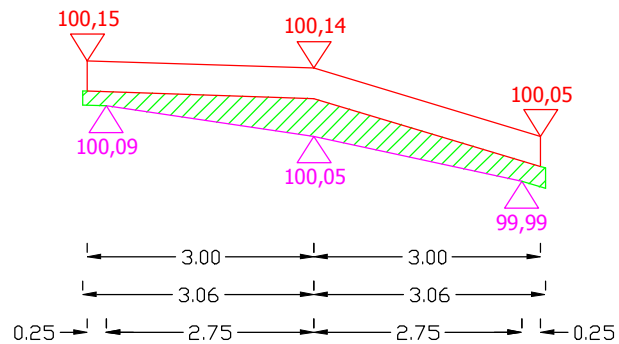

Pwyr.=0,2161 m²

0+064

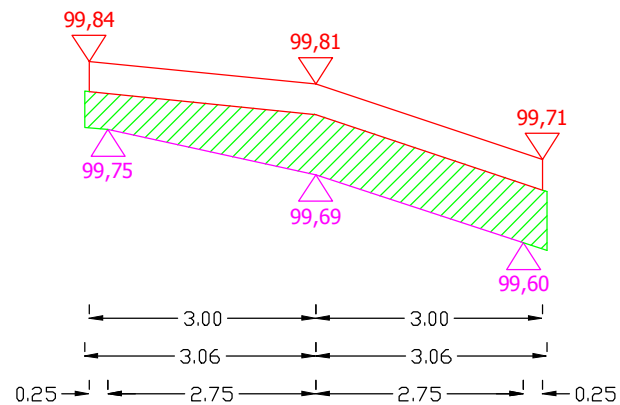

Pwyr.=0,4320 m²

Sporządził:

PRZEKROJE POPRZECZNE DROGI WOJEWÓDZKIEJ NR 651 OD KM 39+816 DO KM 40+810

SKALA 1:10/100

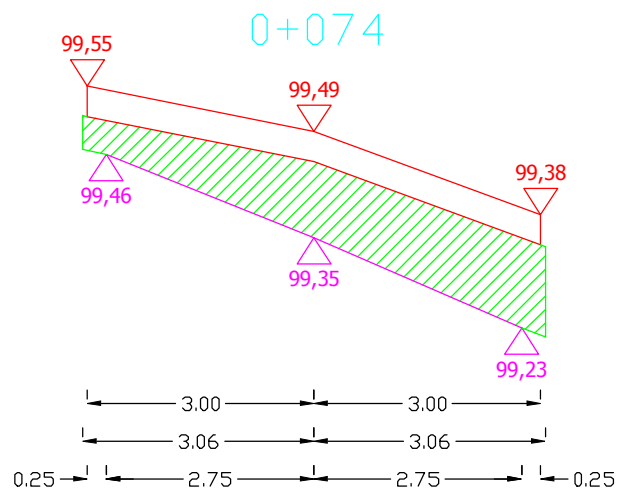

Pwyr.=0,5516 m²

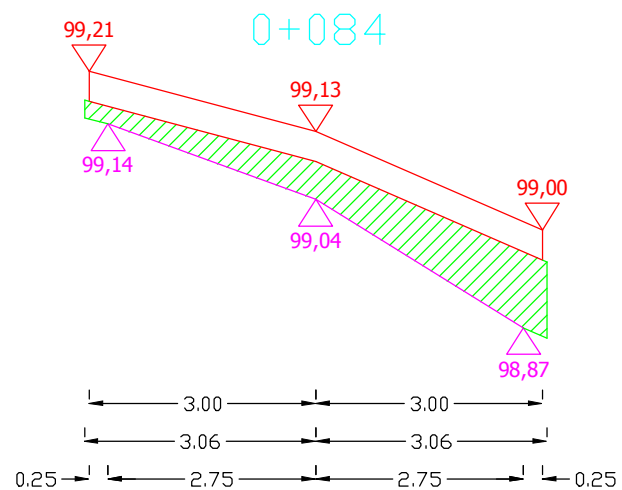

Pwyr.=0,3467 m²

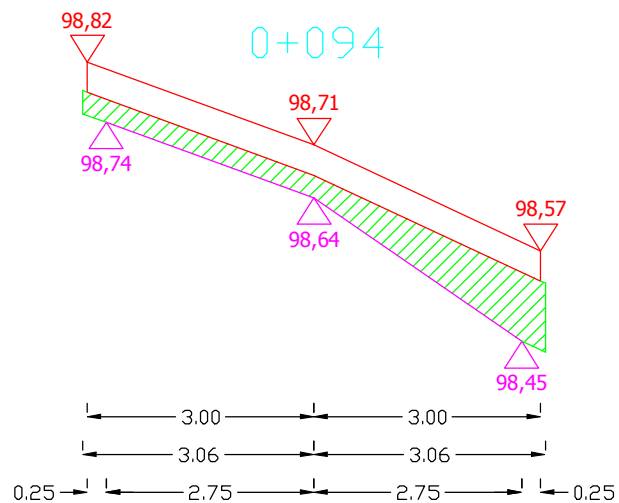

Pwyr.=0,2889 m²

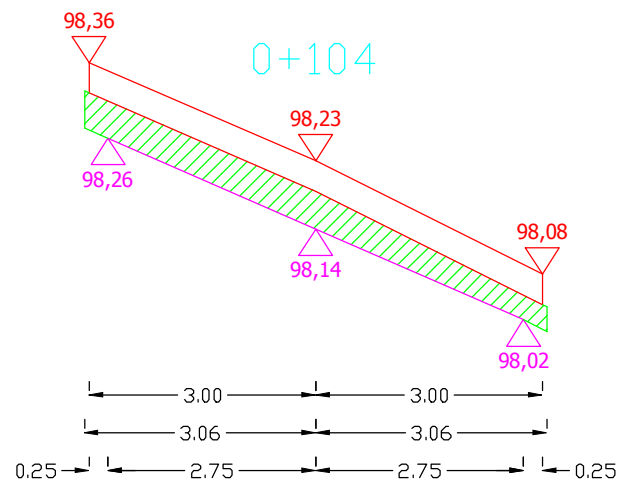

Pwyr.=0,2751 m²

Sporządził:

PRZEKROJE POPRZECZNE DROGI WOJEWÓDZKIEJ NR 651 OD KM 39+816 DO KM 40+810

SKALA 1:10/100

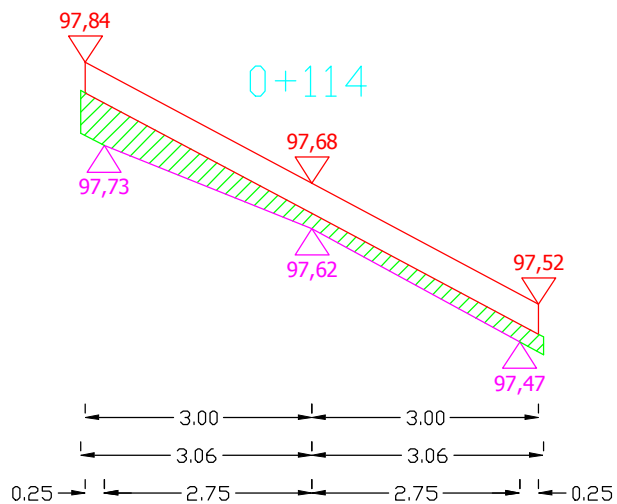

Pwyr.=0,1898 m²

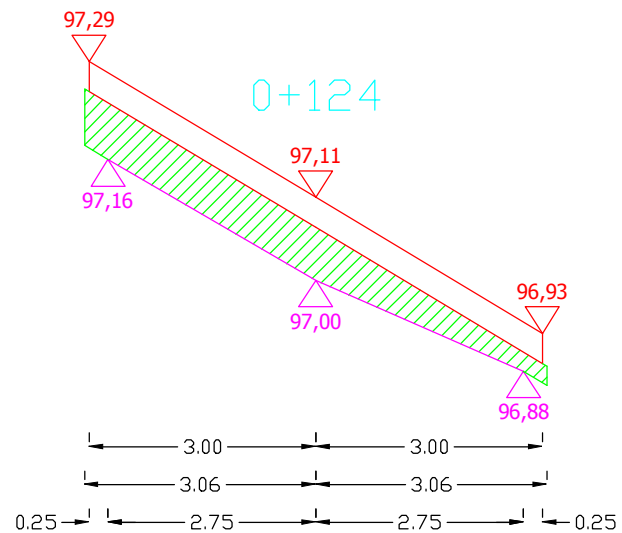

Pwyr.=0,3610 m²

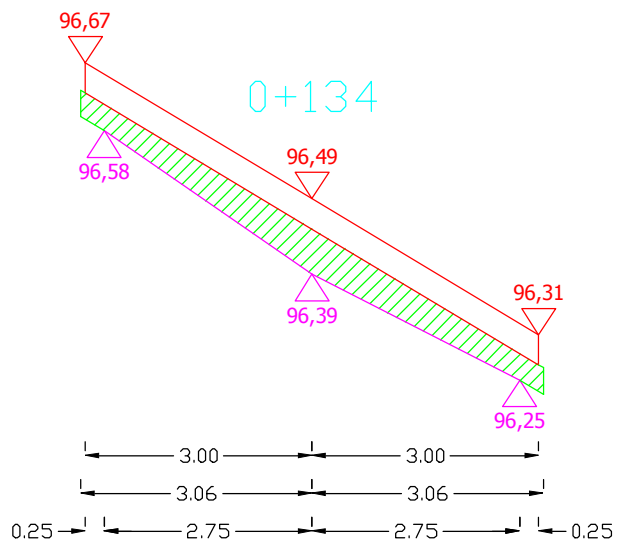

Pwyr.=0,2830 m²

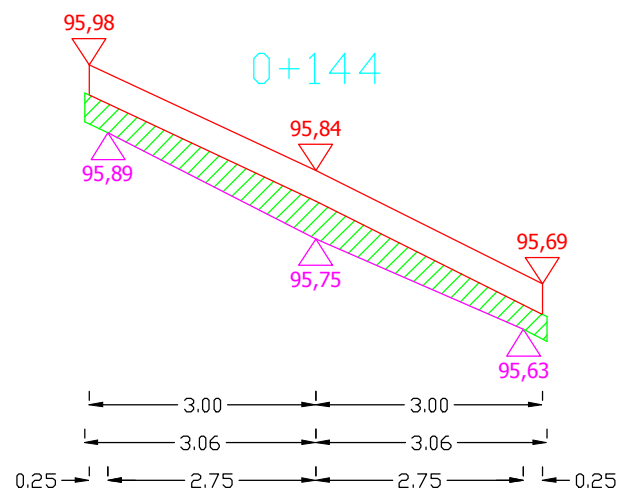

Pwyr.=0,2569 m²

Sporządził:

PRZEKROJE POPRZECZNE DROGI WOJEWÓDZKIEJ NR 651 OD KM 39+816 DO KM 40+810

SKALA 1:10/100

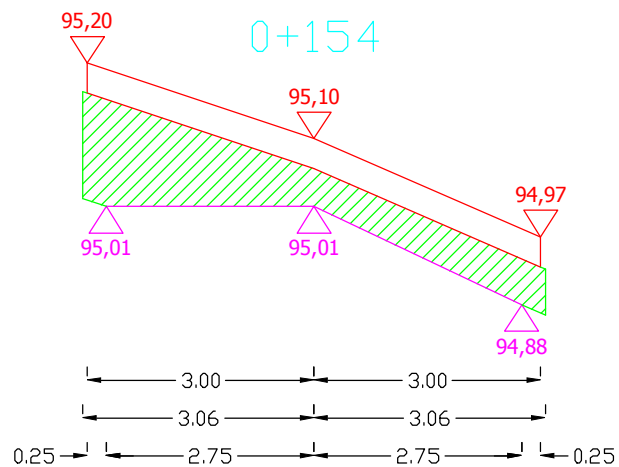

Pwyr.=0,4787 m²

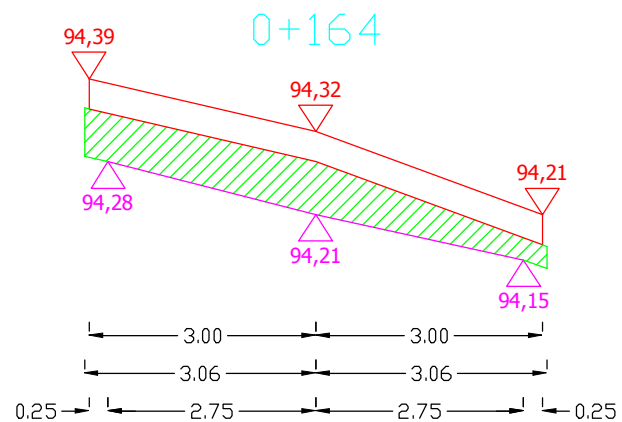

Pwyr.=0,3498 m²

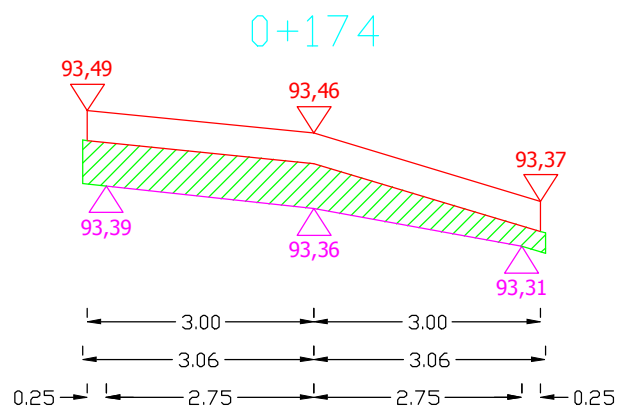

Pwyr.=0,3082 m²

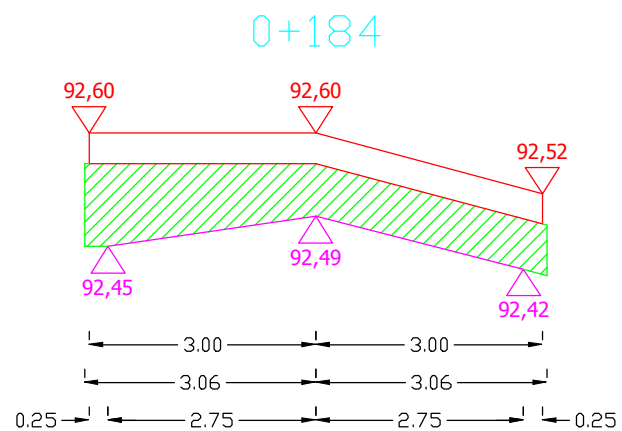

Pwyr.=0,4902 m²

Sporządził:

PRZEKROJE POPRZECZNE DROGI WOJEWÓDZKIEJ NR 651 OD KM 39+816 DO KM 40+810

SKALA 1:10/100

0+194

Pwyr.=0,3307 m²

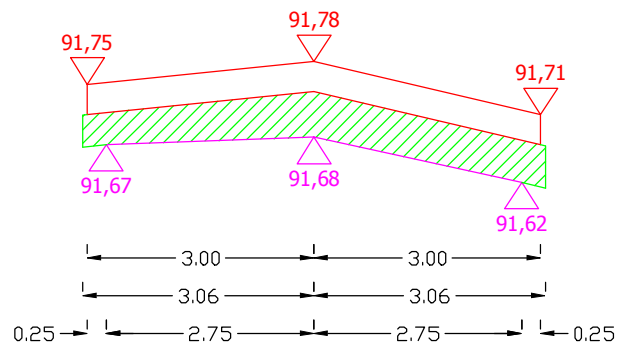

0+204

Pwyr.=0,3397 m²

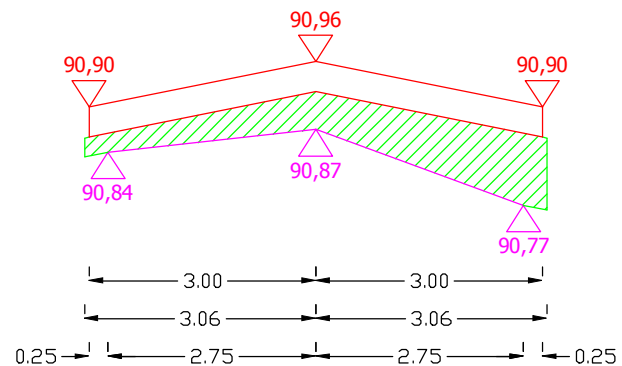

0+214

Pwyr.=0,4896 m²

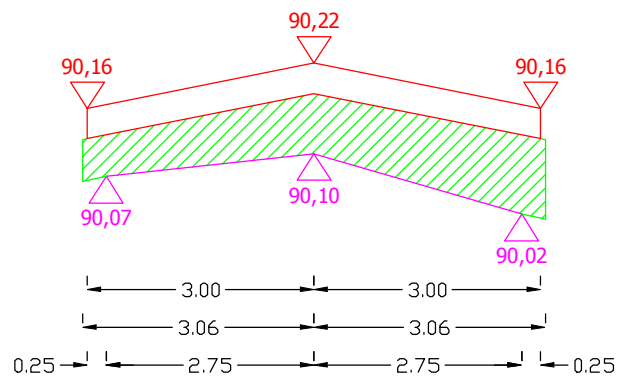

0+224

Pwyr.=0,3167 m²

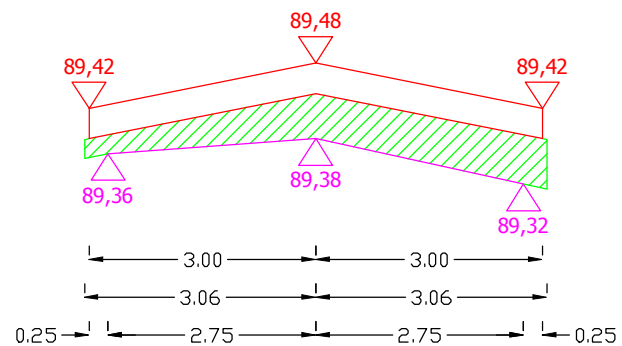

Sporządził:

PRZEKROJE POPRZECZNE DROGI WOJEWÓDZKIEJ NR 651 OD KM 39+816 DO KM 40+810

SKALA 1:10/100

0+234

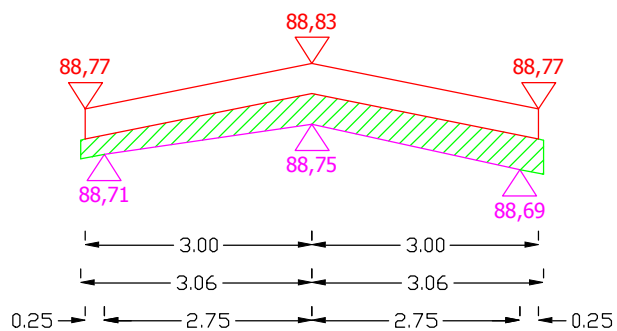

Pwyr.=0,2280 m²

0+244

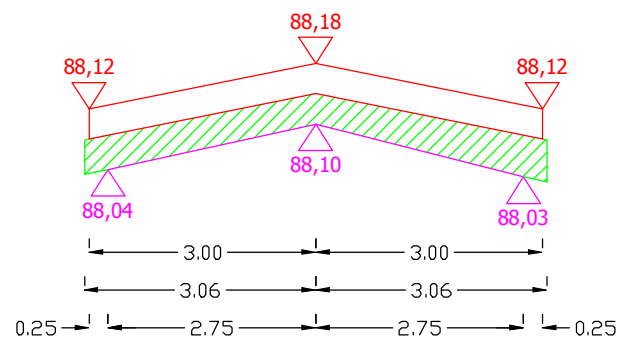

Pwyr.=0,2785 m²

0+254

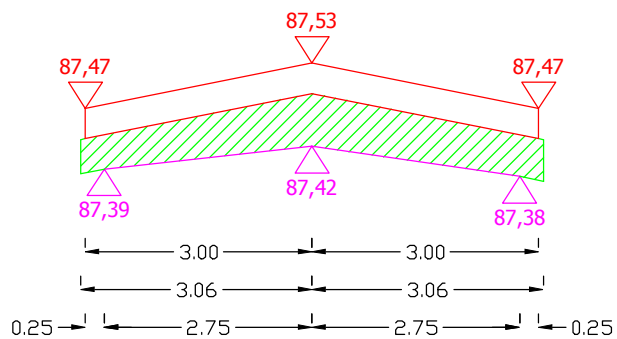

Pwyr.=0,3610 m²

0+264

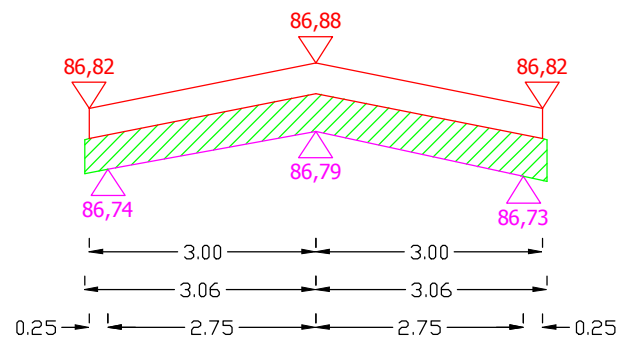

Pwyr.=0,3060 m²

Sporządził:

PRZEKROJE POPRZECZNE DROGI WOJEWÓDZKIEJ NR 651 OD KM 39+816 DO KM 40+810

SKALA 1:10/100

0+274

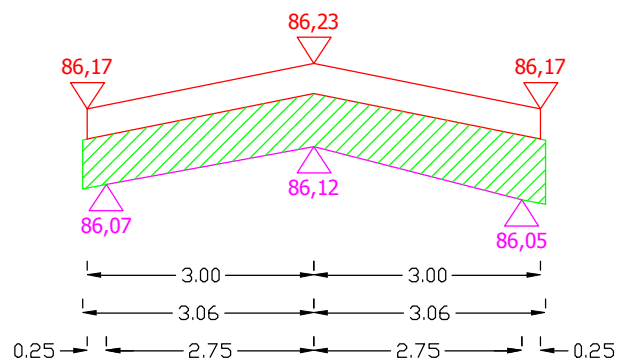

Pwyr.=0,4453 m²

0+284

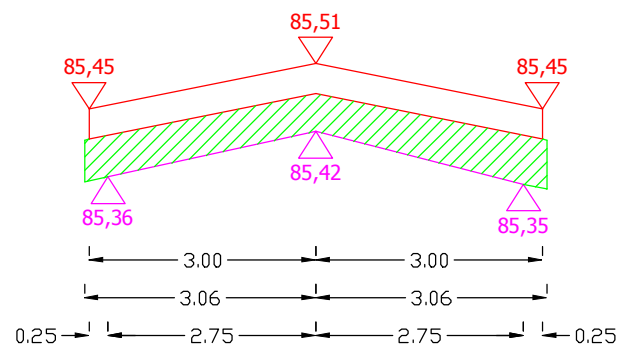

Pwyr.=0,3397 m²

0+294

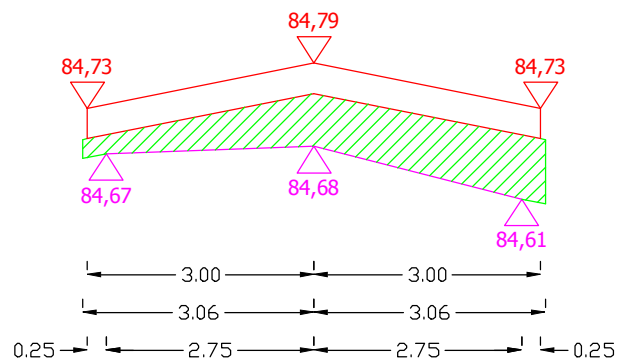

Pwyr.=0,3779 m²

0+304

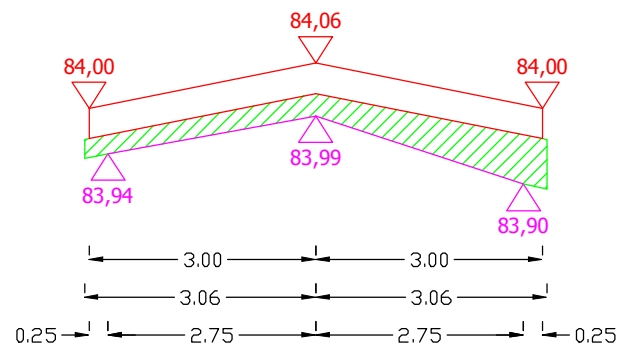

Pwyr.=0,2342 m²

Sporządził:

PRZEKROJE POPRZECZNE DROGI WOJEWÓDZKIEJ NR 651 OD KM 39+816 DO KM 40+810

SKALA 1:10/100

0+314

Pwyr.=0,4453 m²

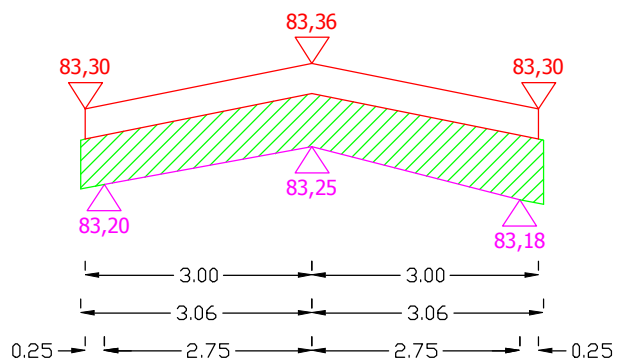

0+324

Pwyr.=0,6014 m²

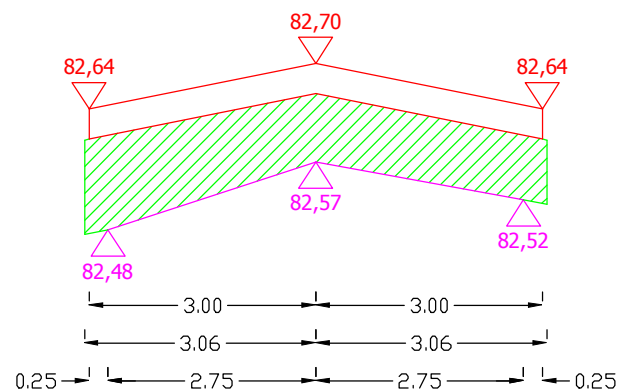

0+334

Pwyr.=0,3841 m²

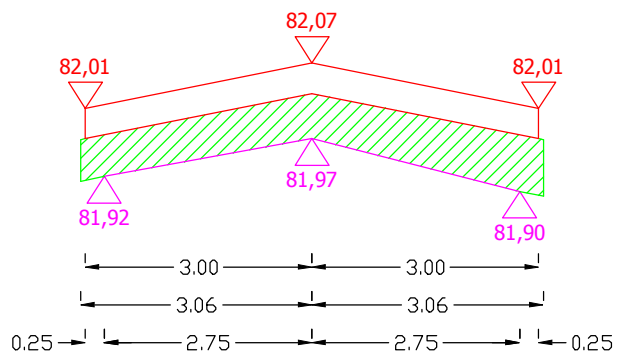

0+344

Pwyr.=0,3229 m²

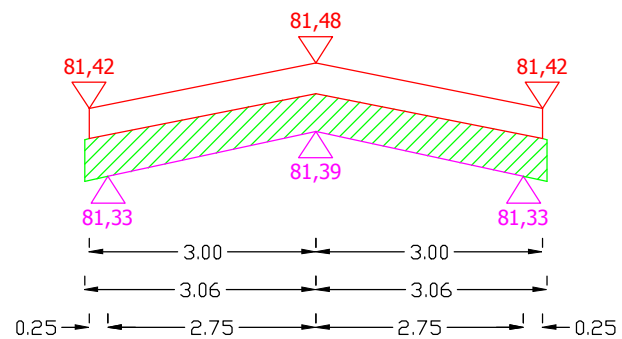

Sporządził:

PRZEKROJE POPRZECZNE DROGI WOJEWÓDZKIEJ NR 651 OD KM 39+816 DO KM 40+810

SKALA 1:10/100

0+354

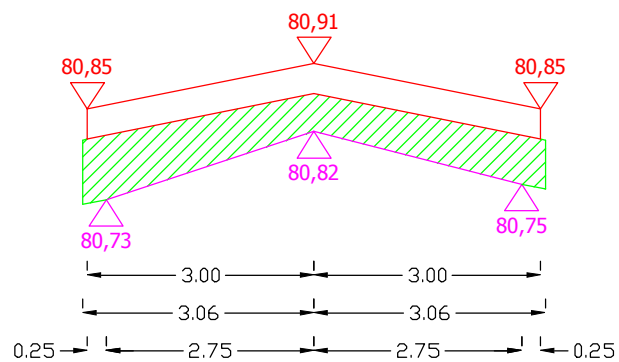

Pwyr.=0,3903 m²

0+364

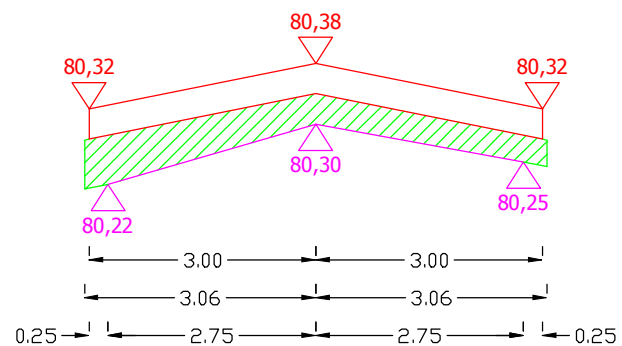

Pwyr.=0,2785 m²

0+374

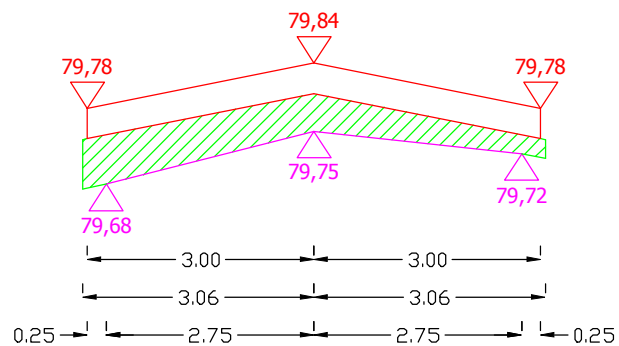

Pwyr.=0,2892 m²

0+384

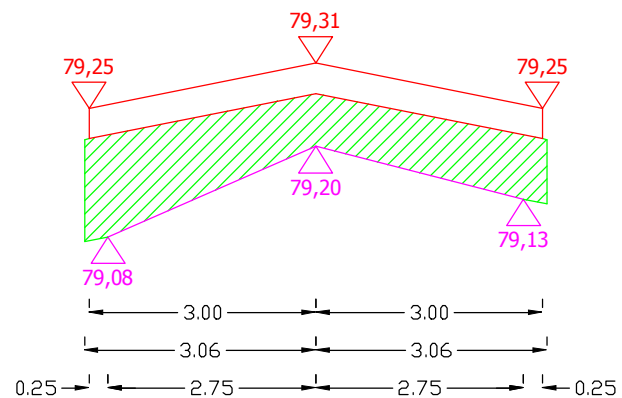

Pwyr.=0,5632 m²

Sporządził:

PRZEKROJE POPRZECZNE DROGI WOJEWÓDZKIEJ NR 651 OD KM 39+816 DO KM 40+810

SKALA 1:10/100

0+394

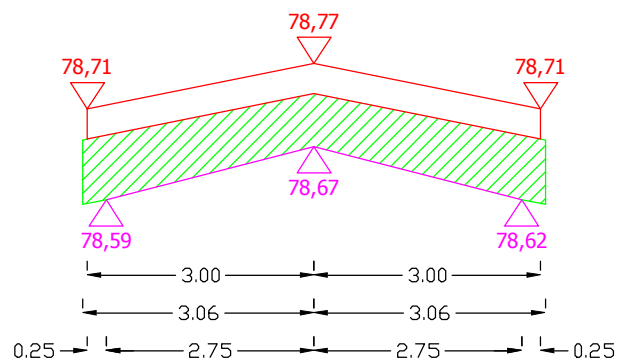

Pwyr.=0,4790 m²

0+404

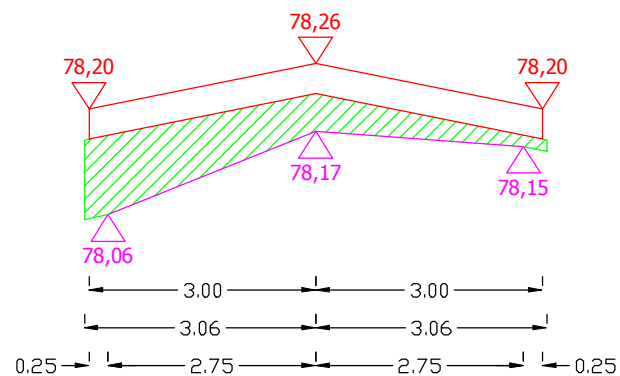

Pwyr.=0,3397 m²

0+414

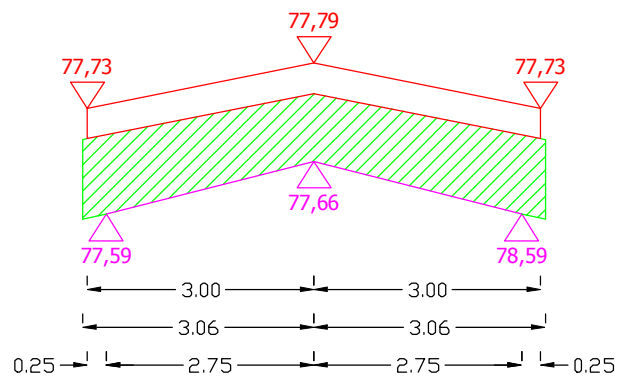

Pwyr.=0,6013 m²

0+424

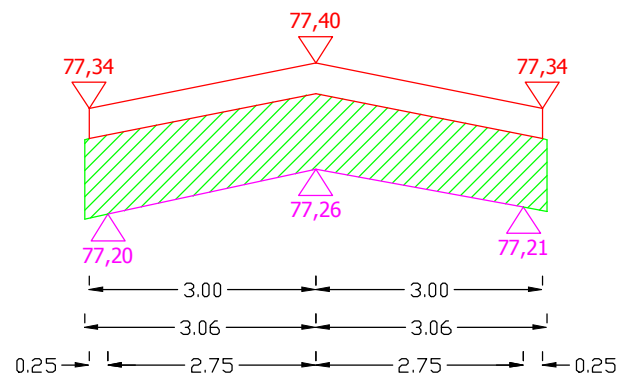

Pwyr.=0,6120 m²

Sporządził:

PRZEKROJE POPRZECZNE DROGI WOJEWÓDZKIEJ NR 651 OD KM 39+816 DO KM 40+810

SKALA 1:10/100

0+434

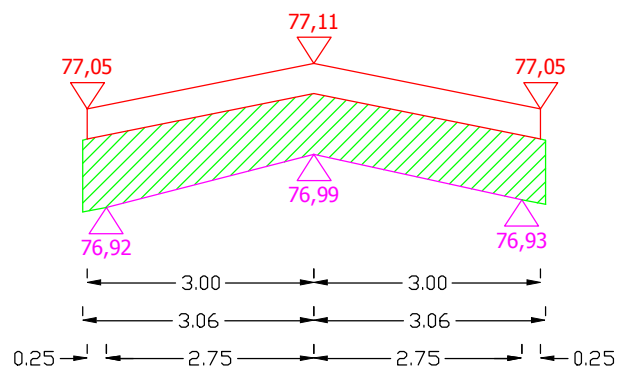

Pwyr.=0,5233 m²

0+444

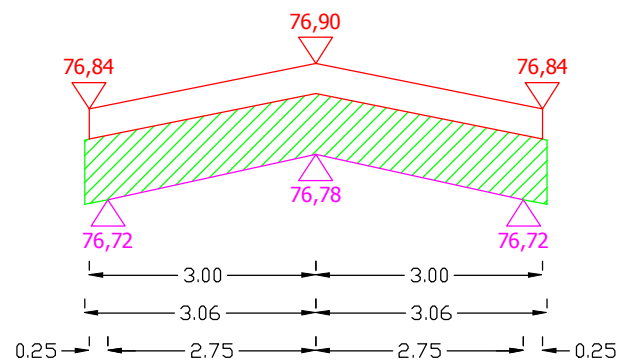

Pwyr.=0,5065 m²

0+454

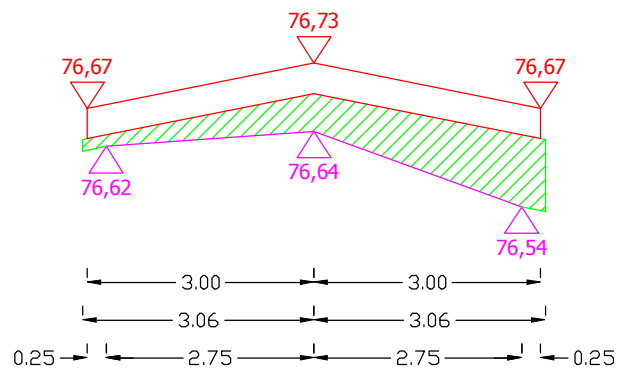

Pwyr.=0,3229 m²

0+464

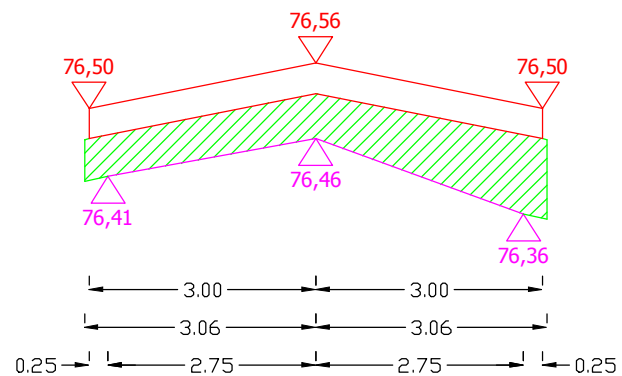

Pwyr.=0,4346 m²

Sporządził:

PRZEKROJE POPRZECZNE DROGI WOJEWÓDZKIEJ NR 651 OD KM 39+816 DO KM 40+810

SKALA 1:10/100

0+474

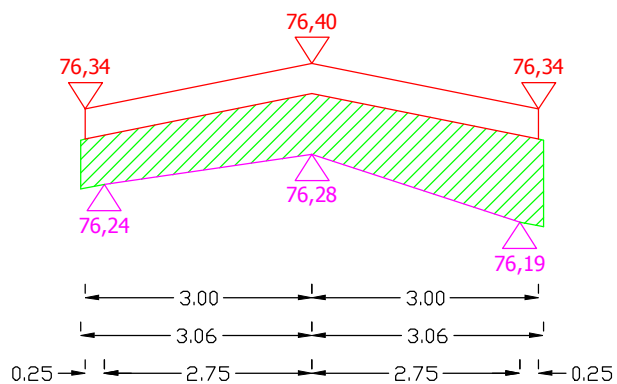

Pwyr.=0,5233 m²

0+484

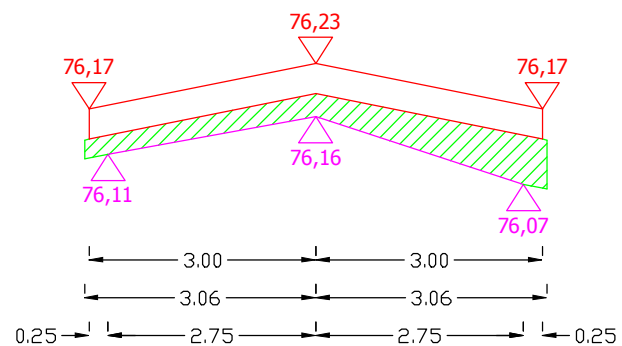

Pwyr.=0,2342 m²

0+494

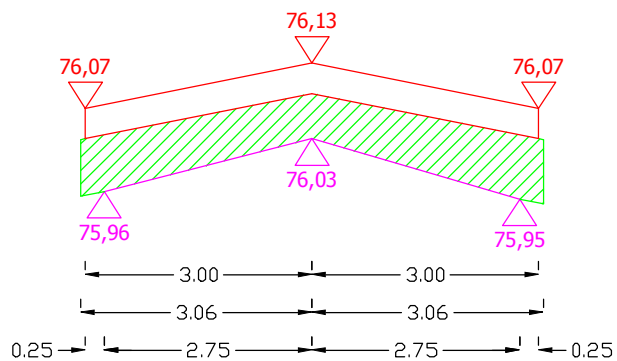

Pwyr.=0,4346 m²

0+504

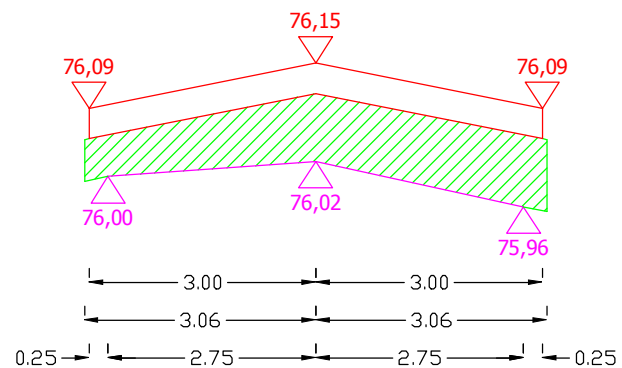

Pwyr.=0,5003 m²

Sporządził:

PRZEKROJE POPRZECZNE DROGI WOJEWÓDZKIEJ NR 651 OD KM 39+816 DO KM 40+810

SKALA 1:10/100

0+514

Pwyr.=0,6120 m²

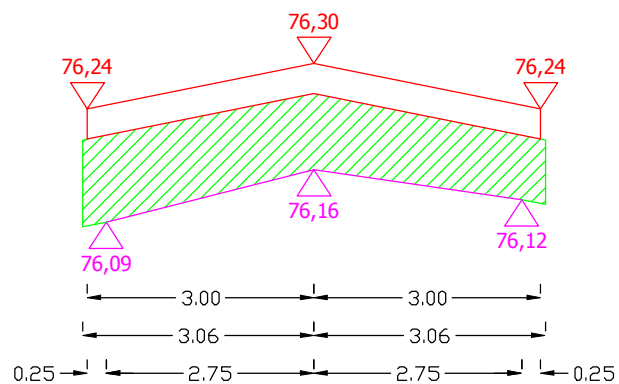

0+524

Pwyr.=0,5082 m²

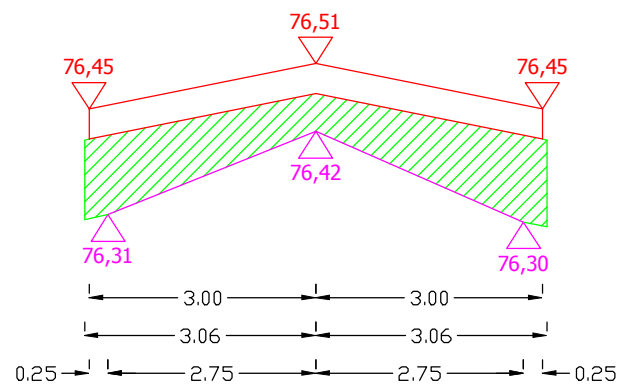

0+534

Pwyr.=0,3060 m²

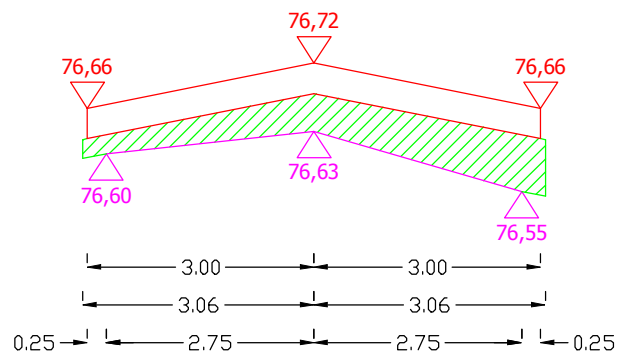

0+544

Pwyr.=0,3291 m²

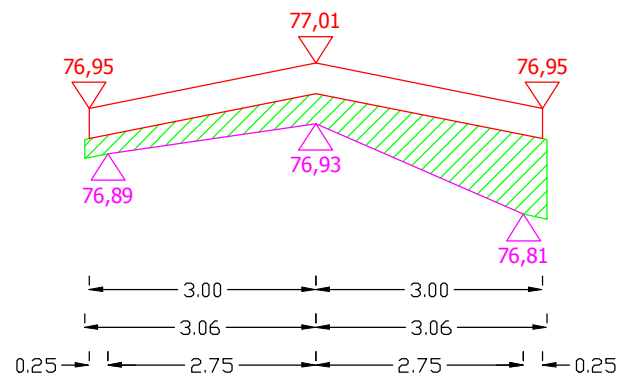

Sporządził:

PRZEKROJE POPRZECZNE DROGI WOJEWÓDZKIEJ NR 651 OD KM 39+816 DO KM 40+810

SKALA 1:10/100

0+554

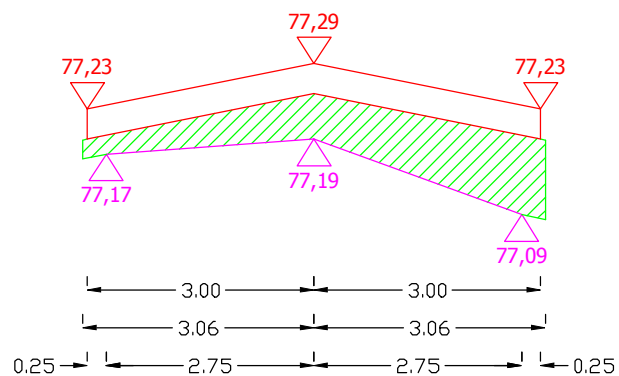

Pwyr.=0,3841 m²

0+564

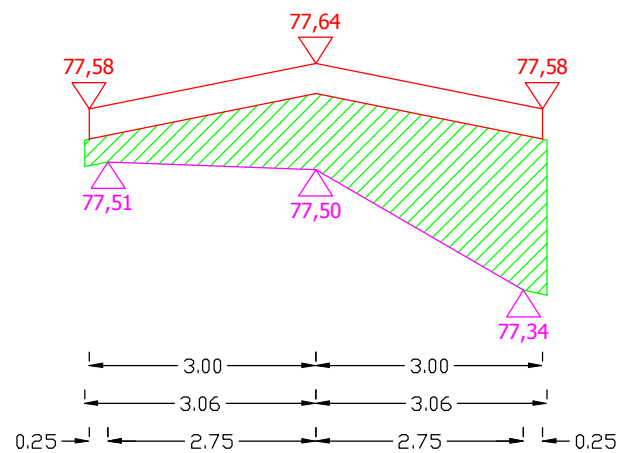

Pwyr.=0,6794 m²

0+574

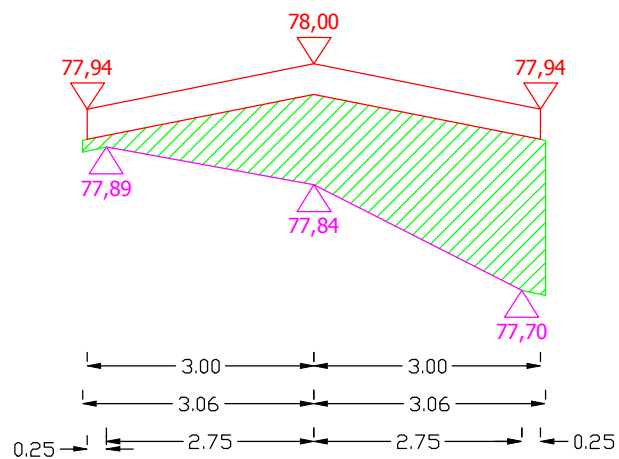

Pwyr.=0,7007 m²

0+584

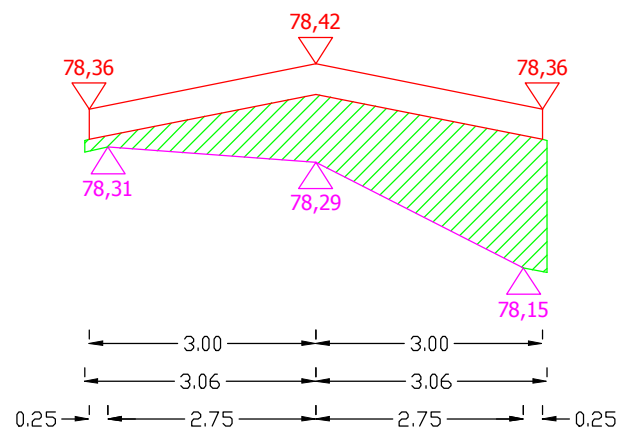

Pwyr.=0,5677 m²

Sporządził:

PRZEKROJE POPRZECZNE DROGI WOJEWÓDZKIEJ NR 651 OD KM 39+816 DO KM 40+810

SKALA 1:10/100

0+594

Pwyr.=0,7406 m²

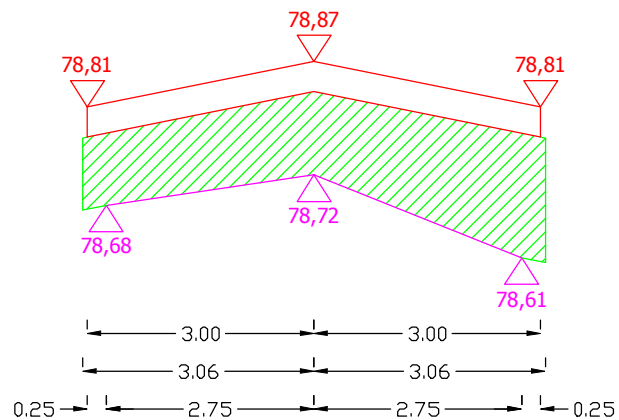

0+604

Pwyr.=0,6901 m²

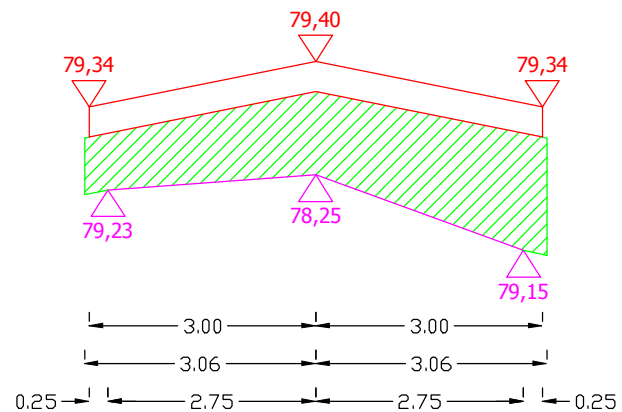

0+614

Pwyr.=0,6120 m²

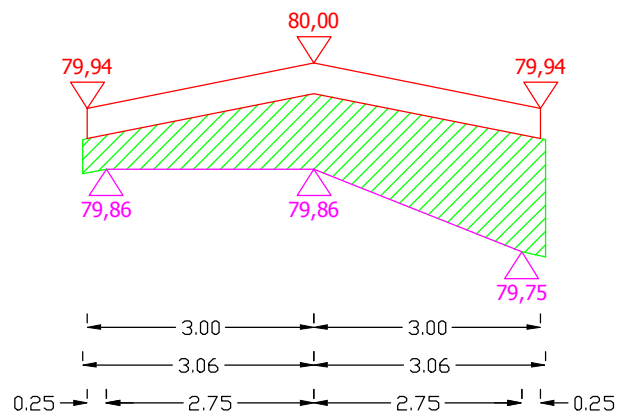

0+624

Pwyr.=0,4958 m²

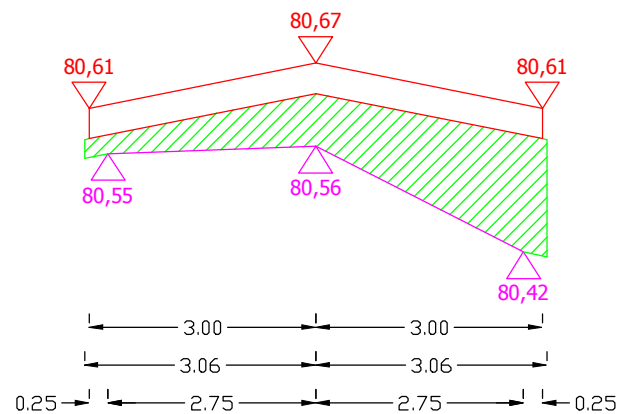

Sporządził:

PRZEKROJE POPRZECZNE DROGI WOJEWÓDZKIEJ NR 651 OD KM 39+816 DO KM 40+810

SKALA 1:10/100

0+634

Pwyr.=0,4621 m²

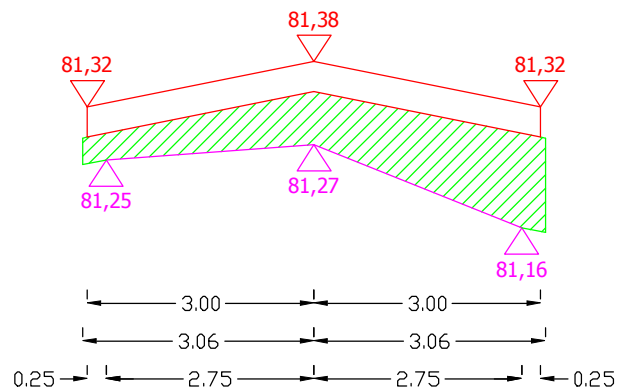

0+644

Pwyr.=0,5340 m²

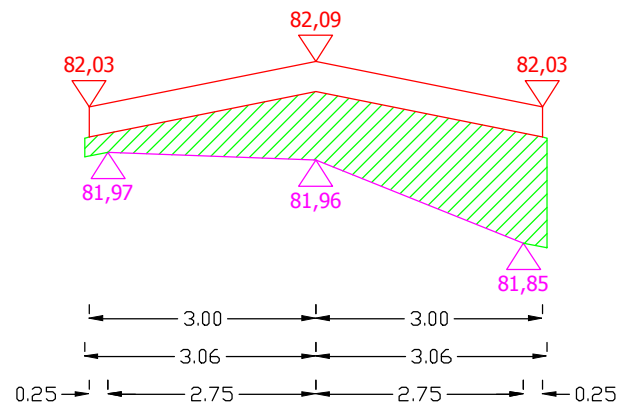

0+654

Pwyr.=0,5570 m²

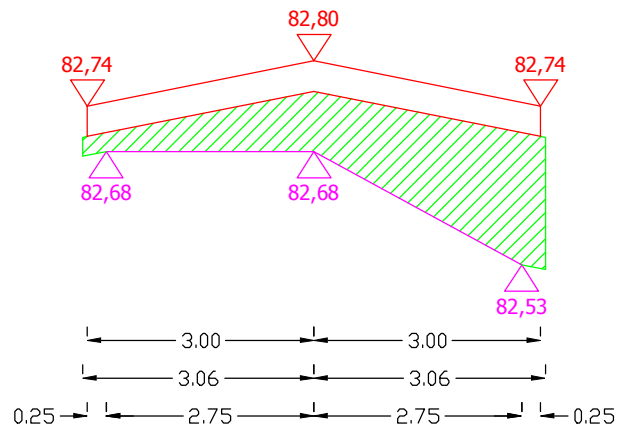

0+664

Pwyr.=0,4453 m²

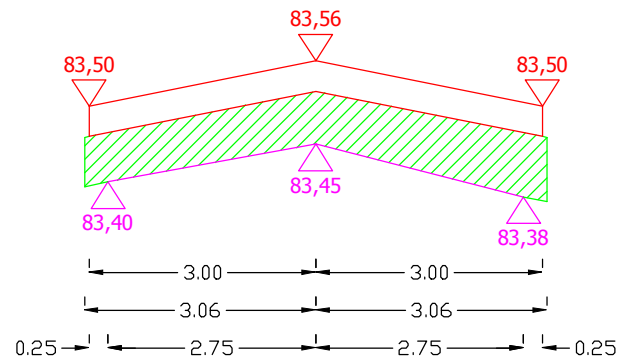

Sporządził:

PRZEKROJE POPRZECZNE DROGI WOJEWÓDZKIEJ NR 651 OD KM 39+816 DO KM 40+810

SKALA 1:10/100

0+674

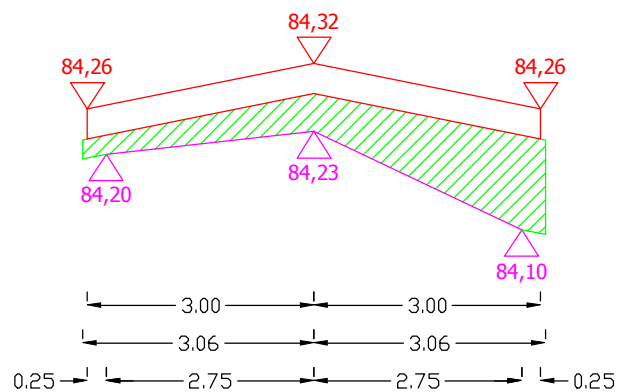

Pwyr.=0,3903 m²

0+684

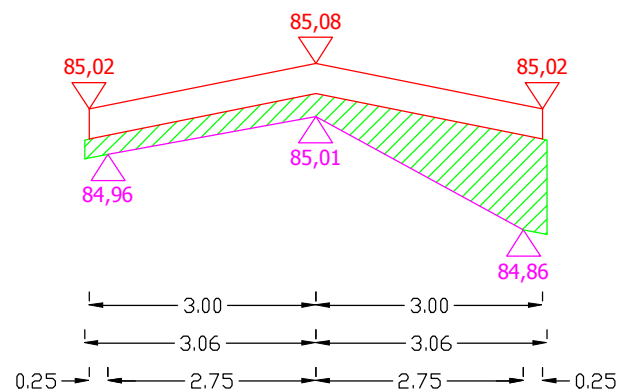

Pwyr.=0,3353 m²

0+694

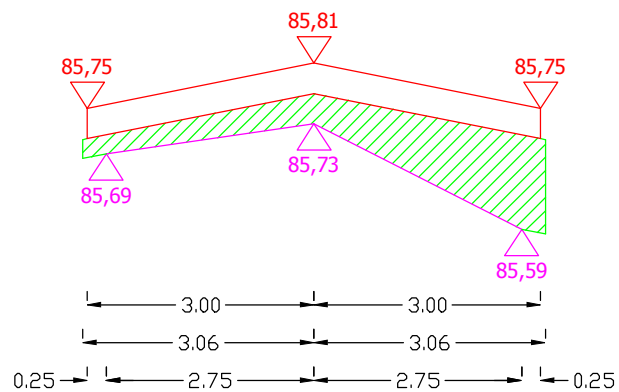

Pwyr.=0,3628 m²

0+704

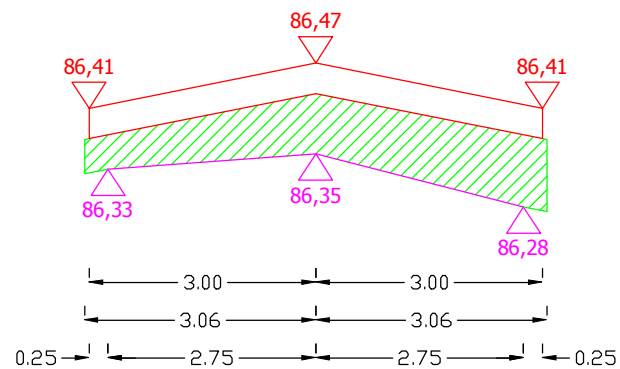

Pwyr.=0,4559 m²

Sporządził:

PRZEKROJE POPRZECZNE DROGI WOJEWÓDZKIEJ NR 651 OD KM 39+816 DO KM 40+810

SKALA 1:10/100

0+714

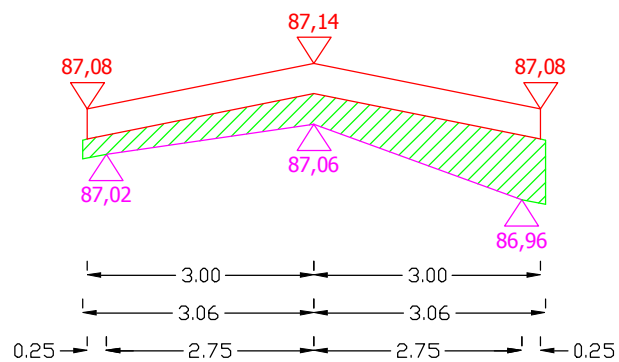

Pwyr.=0,2954 m²

0+724

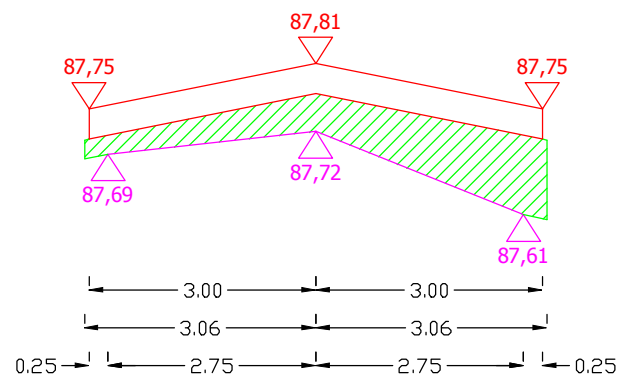

Pwyr.=0,3566 m²

0+734

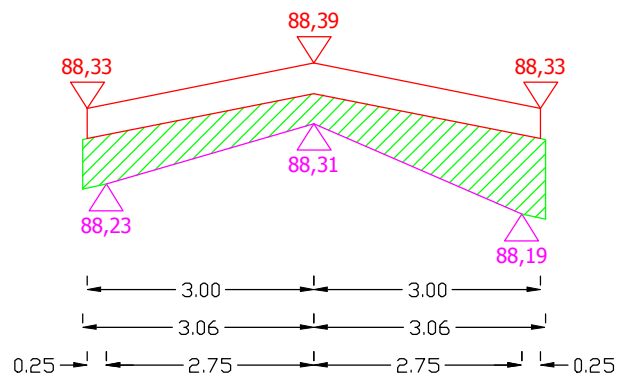

Pwyr.=0,3965 m²

0+744

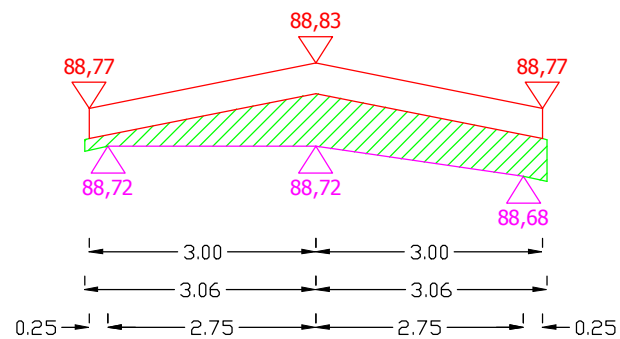

Pwyr.=0,3105 m²

Sporządził:

PRZEKROJE POPRZECZNE DROGI WOJEWÓDZKIEJ NR 651 OD KM 39+816 DO KM 40+810

SKALA 1:10/100

0+754

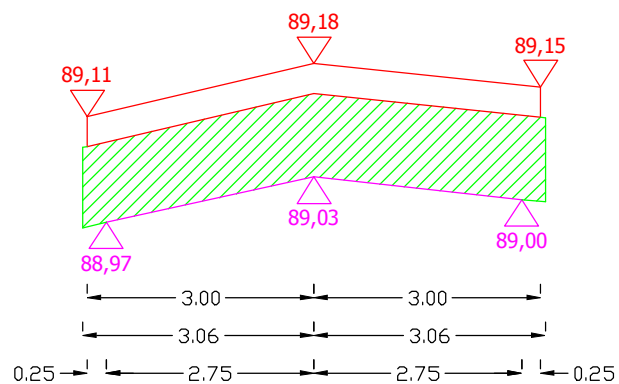

Pwyr.=0,6697 m²

0+764

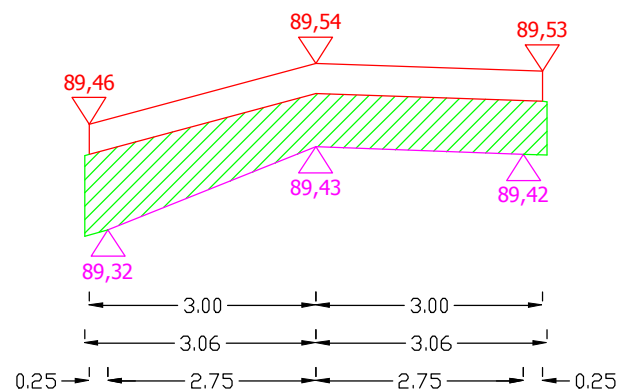

Pwyr.=0,4916 m²

0+774

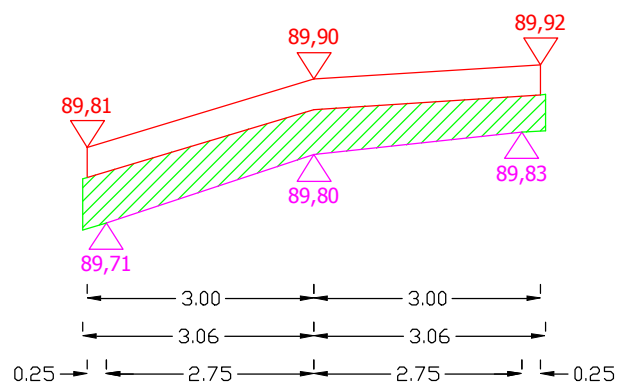

Pwyr.=0,3592 m²

0+784

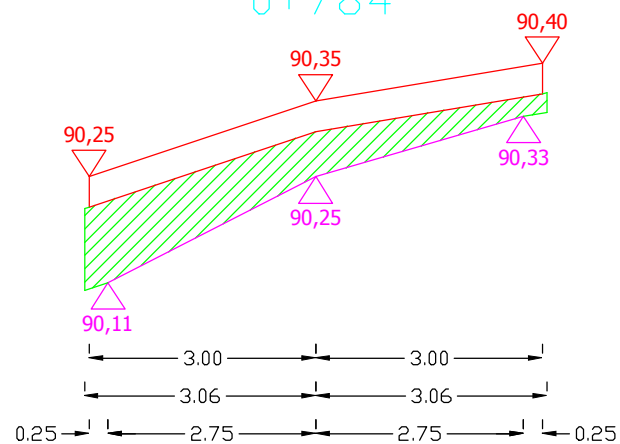

Pwyr.=0,3911 m²

Sporządził:

PRZEKROJE POPRZECZNE DROGI WOJEWÓDZKIEJ NR 651 OD KM 39+816 DO KM 40+810

SKALA 1:10/100

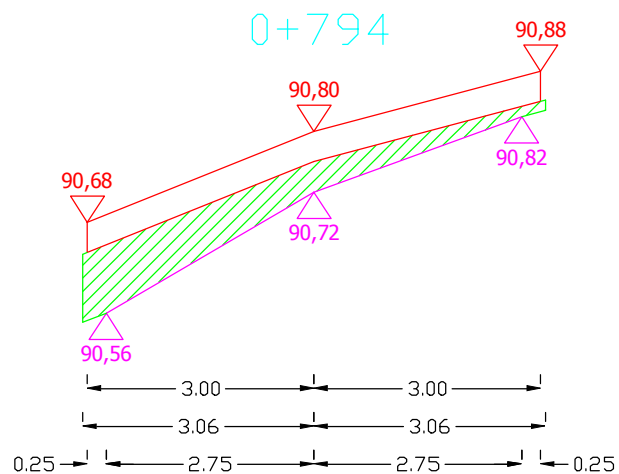

Pwyr.=0,2841 m²

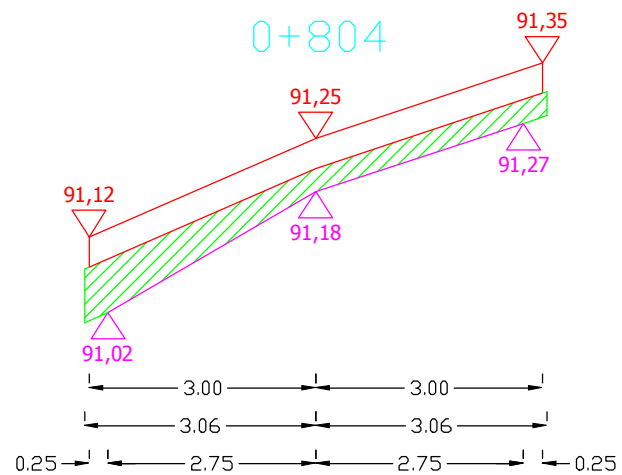

Pwyr.=0,2552 m²

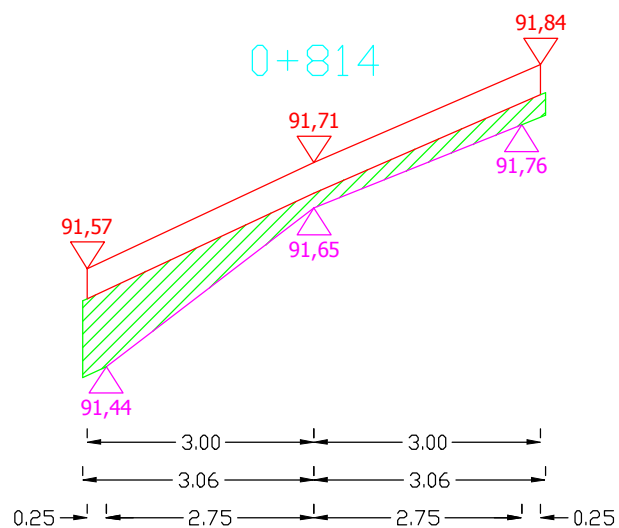

Pwyr.=0,2755 m²

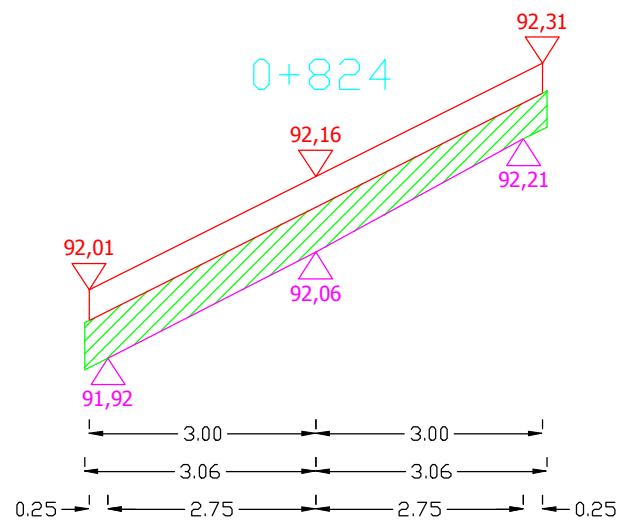

Pwyr.=0,3518 m²

Sporządził:

PRZEKROJE POPRZECZNE DROGI WOJEWÓDZKIEJ NR 651 OD KM 39+816 DO KM 40+810

SKALA 1:10/100

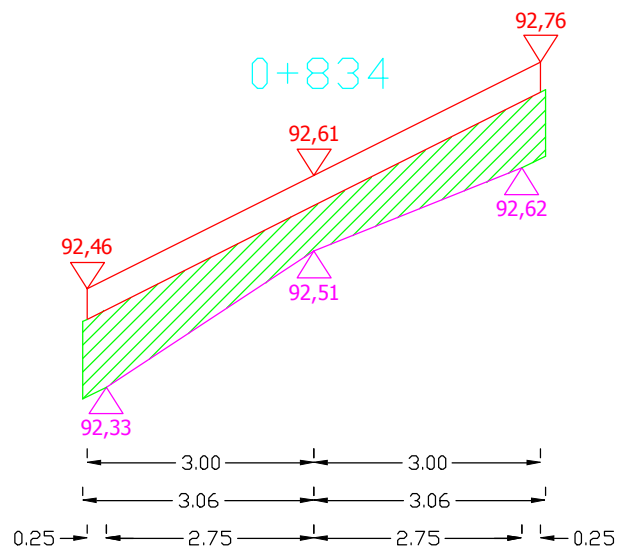

Pwyr.=0,4859 m²

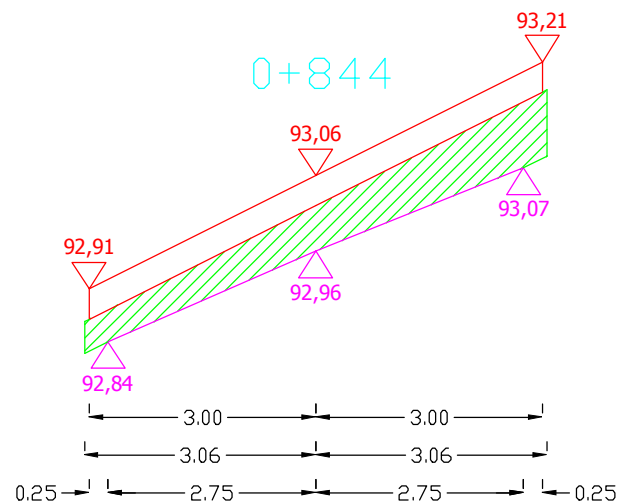

Pwyr.=0,3848 m²

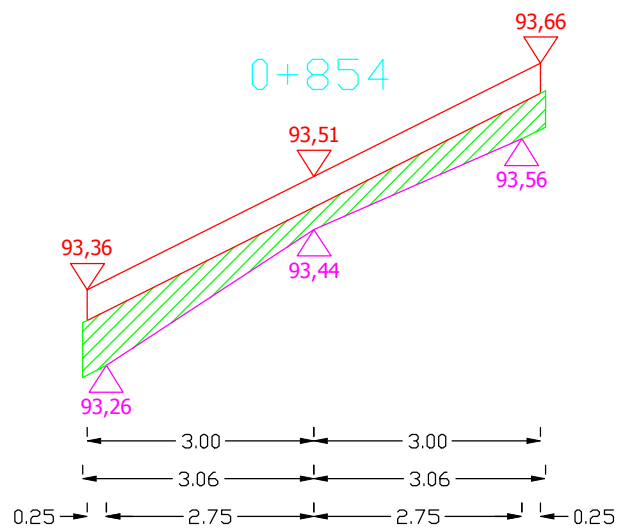

Pwyr.=0,2862 m²

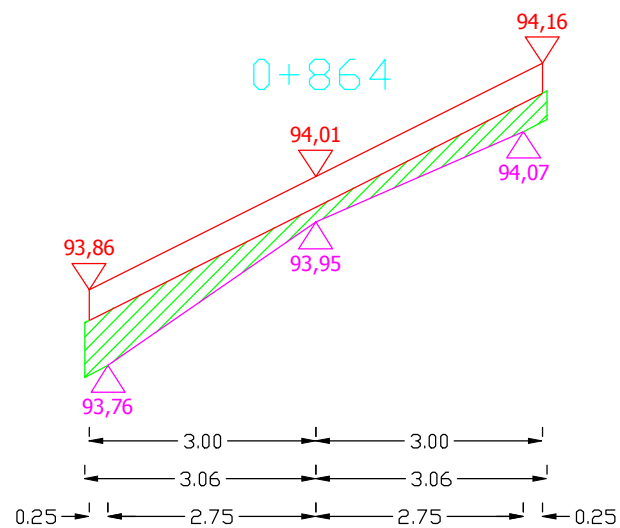

Pwyr.=0,2418 m²

Sporządził:

PRZEKROJE POPRZECZNE DROGI WOJEWÓDZKIEJ NR 651 OD KM 39+816 DO KM 40+810

SKALA 1:10/100

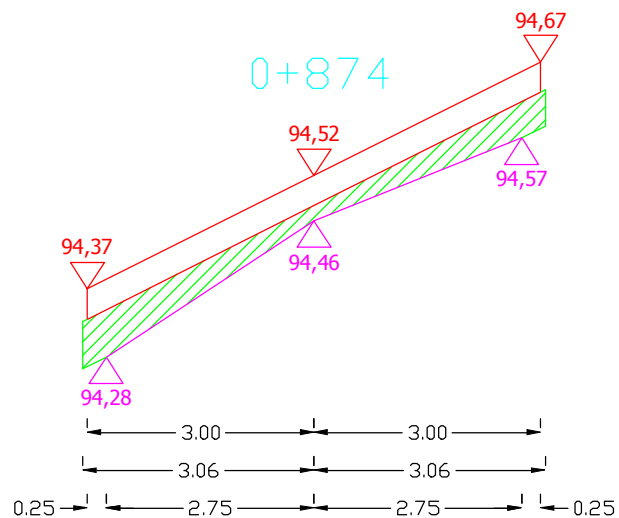

Pwyr.=0,2418 m²

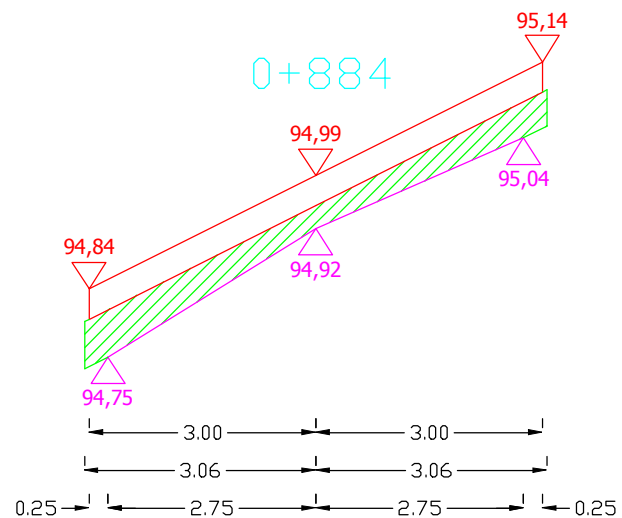

Pwyr.=0,2693 m²

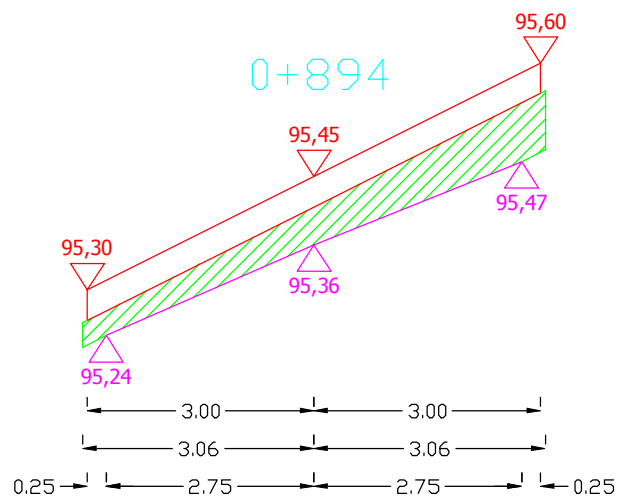

Pwyr.=0,3243 m²

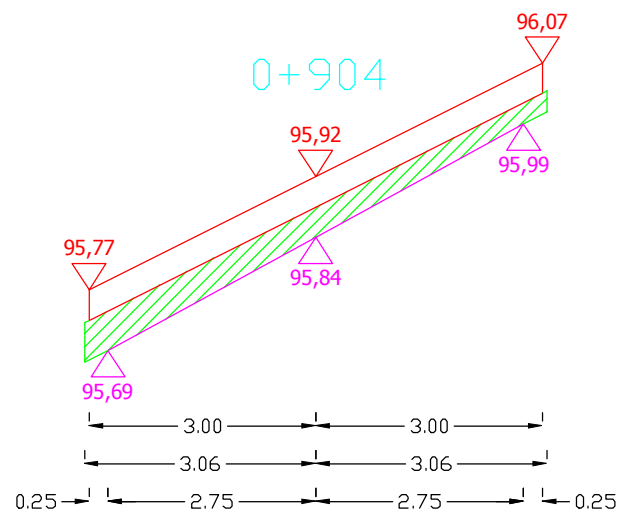

Pwyr.=0,2463 m²

Sporządził:

PRZEKROJE POPRZECZNE DROGI WOJEWÓDZKIEJ NR 651 OD KM 39+816 DO KM 40+810

SKALA 1:10/100

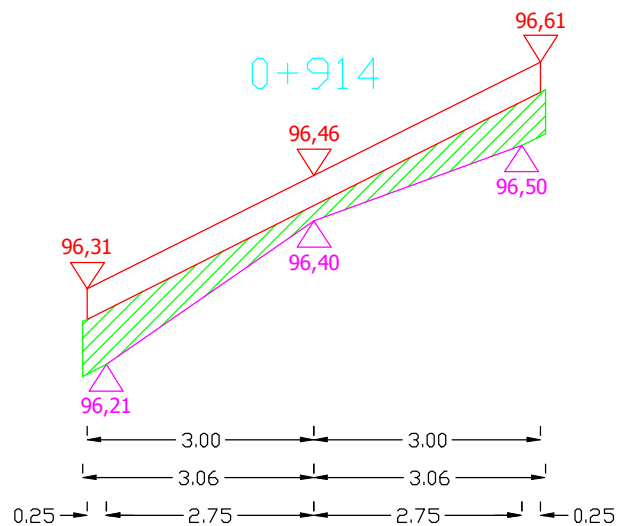

Pwyr.=0,2755 m²

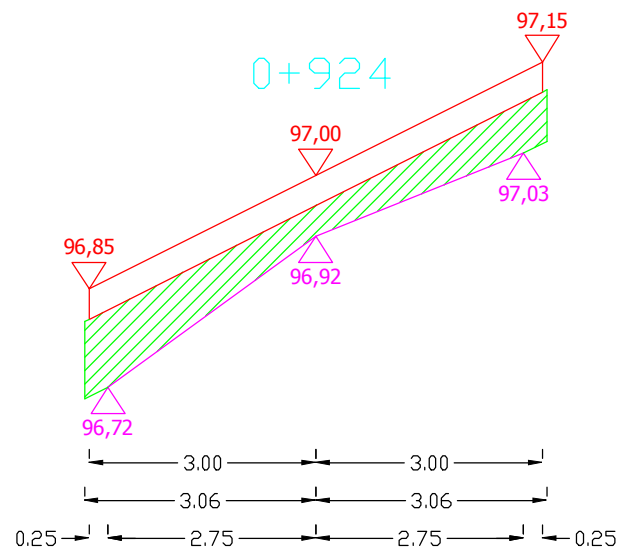

Pwyr.=0,3979 m²

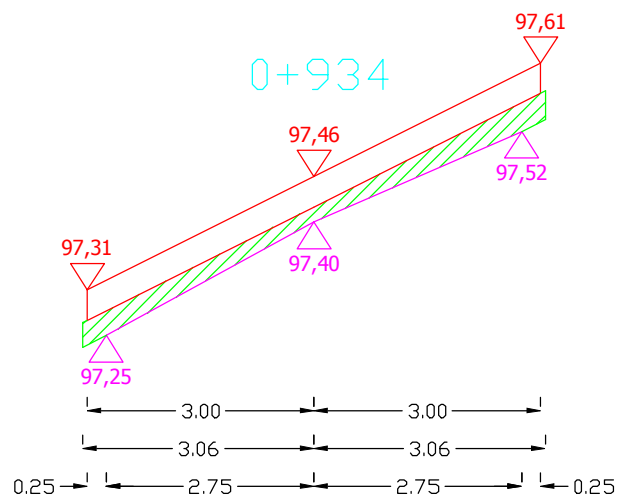

Pwyr.=0,1746 m²

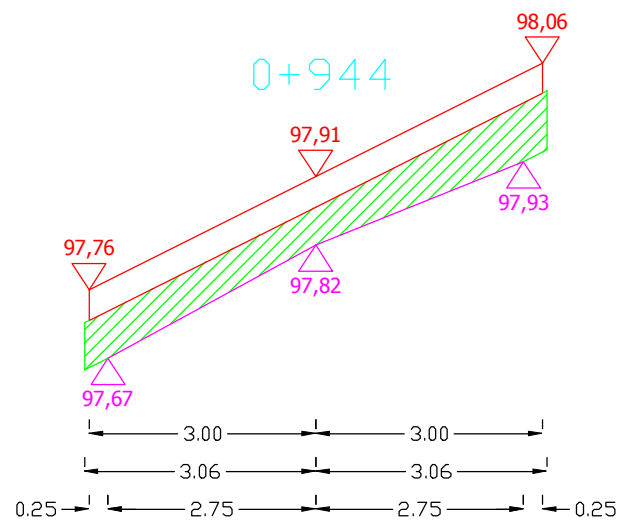

Pwyr.=0,3749 m²

Sporządził:

PRZEKROJE POPRZECZNE DROGI WOJEWÓDZKIEJ NR 651 OD KM 39+816 DO KM 40+810

SKALA 1:10/100

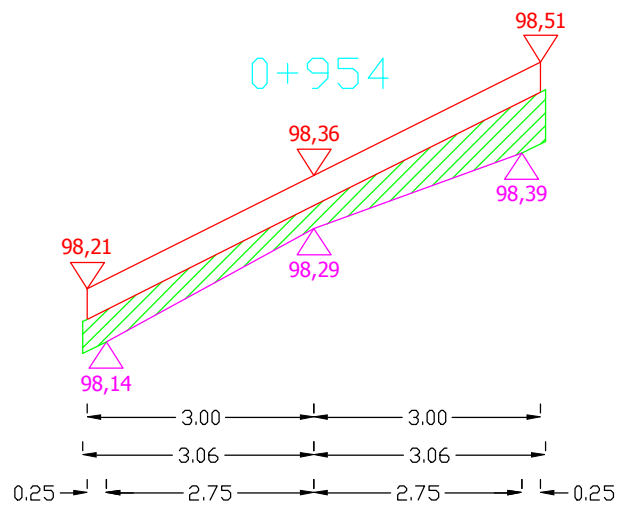

Pwyr.=0,2693 m²

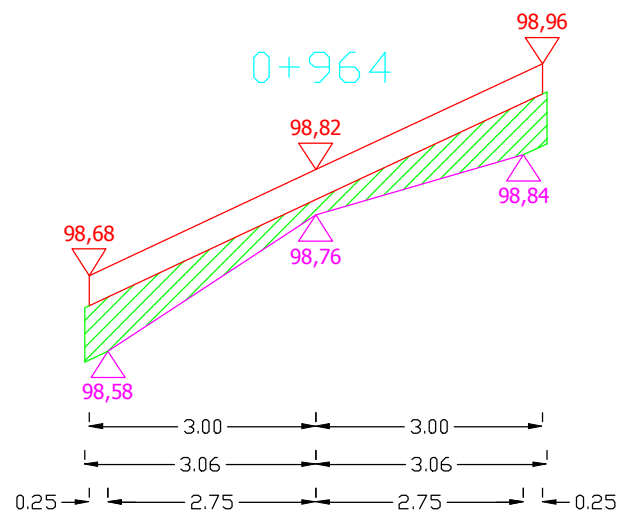

Pwyr.=0,2909 m²

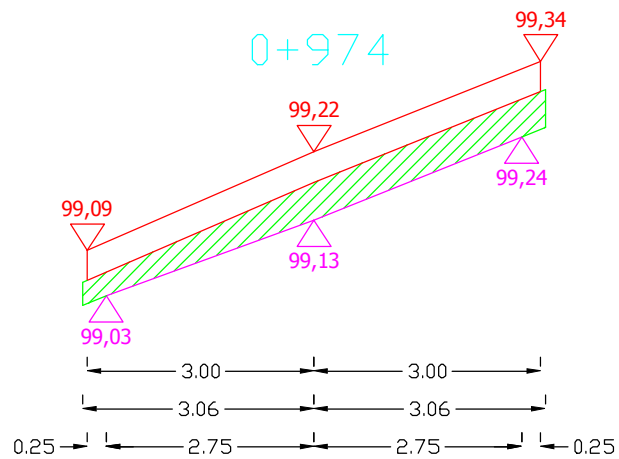

Pwyr.=0,2737 m²

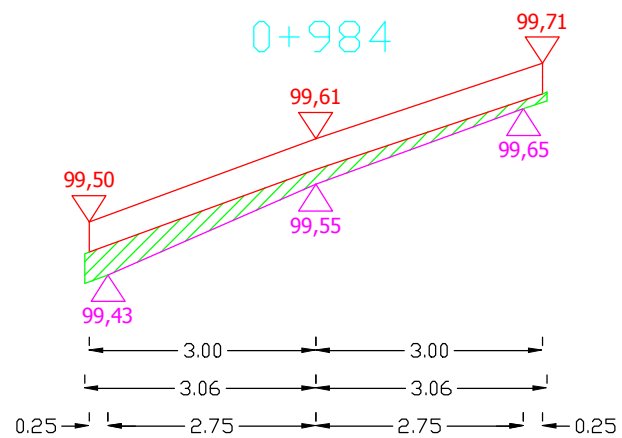

Pwyr.=0,1407 m²

Sporządził:

PRZEKROJE POPRZECZNE DROGI WOJEWÓDZKIEJ NR 651 OD KM 39+816 DO KM 40+810

SKALA 1:10/100

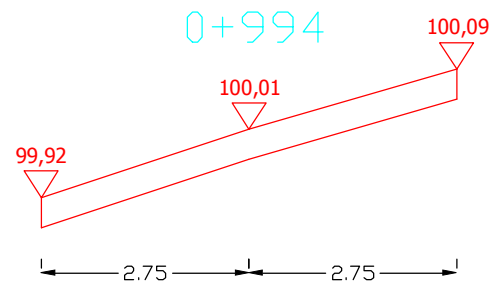

Pwyr.=0,0000m²